

Kewaunee

Wisconsin's Best Kept Secret

**SPIRIT OF THE LAKESHORE 2023
VISITOR & BUSINESS GUIDE**





410 Milwaukee St, Kewaunee, WI
920-388-2890

mail@novakagency.com
www.novakagency.com



Novak Agency is a family-owned business
selling insurance since 1946.
Give us a call today!

INSURANCE SERVICES

AUTO • HOME • BUSINESS
FARM • LIFE • HEALTH
MOTORCYCLE • BOAT





Don & Jean Smith

Don and Jean believed in working together to improve their community. Today their charitable fund continues to support the Kewaunee community.

Some organizations aided by the Donald & Jean Smith Fund

Kewaunee Senior Center
Kewaunee Health & Fitness
Kewaunee County Historical Society
Friends of the Kewaunee Pierhead Lighthouse
Winter Park
Lakehaven Hall
Kewaunee Artisan Center
Kewaunee Chamber of Commerce
Zoological Society of Kewaunee County
City of Kewaunee



Individuals can make a difference.



KEWAUNEE ARTISAN CENTER

A place where folks who share an interest in the arts come to learn, have fun, and enjoy camaraderie with fellow artisans!

Have you always wanted to learn the art of quilting? Would you like to learn traditional baking? Interested in giving painting or drawing a try? Do you or your kids love crafting? If so, come in and take a look at our many classes, and join us at the Kewaunee Artisan Center!

Like our facebook page and visit our website for current classes, and exciting updates & coming events!

401A Harrison St.
Kewaunee, WI 54216
(920) 304-8018

kewauneeartisans@att.net
kewauneeartisancenter.org

SUBWAY

of Kewaunee
1614 Center St. Kewaunee, WI 54216

Kewaunee
RV & Campground
LLC



Rustic cabins, heated swimming pool, full hook up, pull through site, grounds are big rig friendly, bike trail and boat launch nearby.

920-388-4851

www.kewauneerv.com

333 Terraqqa Drive, Kewaunee



Fresh Frozen Custard
Flavor of the Day, Chocolate & Vanilla
Many other frozen delights
Daily specials, burgers, homemade chili
Indoor seating – Drive thru

Hwy 42, PO Box 181, Kewaunee, WI 54216 | (920) 388-0720

MUSIC IN THE PARK

Sponsored by Area Businesses and Kewaunee Area Chamber of Commerce

Join us at the gazebo in Harbor Park downtown Kewaunee every Sunday 5:00-7:30pm. FREE to the public.

- June 18 **Take 2 Acoustic**** A fun acoustic duo.
- June 25 **Fork in the Road Band**** Five professional musicians playing a popular mix of country and classic rock.
- July 2 **Modern Day Drifters**** Our favorite crooners return with over 50 years of country hits and all-time favorites.
- July 9 **Brass Differential**** Green Bay's premier party band. Huge sound and lots of energy.
- July 16 **Conscious Pilot**** An award-winning group of musicians putting together "A fresh and powerful sound that is familiar and fun!"
- July 23 **JNL Company**** a three piece Band of local guys crooning the oldies. Play a variety of hits from every era.
- July 30 **The Cougars**** A 6-piece rock cover band from Green Bay, WI with 3 female vocalists and 3 male instrumentalists.
- August 6 **Greatest Hits Polka Band**** This energetic polka band is sure to get you out of your seat!
- August 13 **Jeff n Shed**** This local duo can pump out tons of acoustic hits. Come watch and find out!
- August 20 **Haley Grace and Alexa Rae**** Visiting all the way from Nashville with a variety of country and rock hits.
- August 27 **Safe Sax**** This is what you get when a saxophone player, a keyboardist, drummer and female singer walk in a bar.



Visit www.kewaunee.org for up to date information.

Food provided by area non-profit organizations. Carry in's allowed.

Bring a blanket, lawn chair, picnic basket, or cooler and relax on the scenic lakeshore.

*Rain Location is located at
Lakehaven Hall,
96 Ellis Street, Kewaunee, WI 54216.
Watch for sign in gazebo.*

215 N MAIN ST KEWAUNEE 920-388-0505

**DAILY FOOD
& DRINK
SPECIALS!**

**DINE IN
OR CARRY
OUT!**



Sun-Tues 11AM-CL
Weds Closed
Thurs 11AM-CL
Fri-Sat 11AM-CL

High School Students
ask for a free beverage
drink card when in!

THE LIGHTHOUSE SHOP

www.lighthousegiftshop.com

- Fudge
- Cherry & Cranberry Products
- Apparel
- Outdoor Lawn Ornaments
- Nautical Decor

*Suites
overlooking the
river valley
and Kewaunee
harbor!*

COHO MOTEL

www.cohomotel.com

- Seasonal Rates
- Ample Boat Parking
- In-Room Refrigerator, Coffee Maker, and Microwave
- High-Speed Wireless Internet and Cable



Veteran Owned



705 N. Main Street, Hwy 42, Kewaunee, WI 54216 • (920) 388-3565

2023 CONCERT EVENTS

Algoma Concerts in the Park

Thursday nights 7pm at Heritage Park. Free Admission. Bands are subject to change. Follow Algoma Concerts in the Park on Facebook for updates!.

June 29	The Cougars
July 6	Big Mouth & The Power Tool Horns
July 13	Modern Day Drifters
July 20	Got Wisco
July 27	Conscious Pilot
August 3	Copper Box
August 10	Stephen Cooper & The Nobody Famous

Luxemburg Music in the Park

Thursday nights 6pm at Fireman's Park. Free to attend, FUN for the whole family! For more information visit www.luxemburgchamber.com.

Mishicot Concerts at the School

June – August MAGIC proudly presents Concerts at the School Music Series! Wednesday evenings in the great out of doors on the grounds of Mishicot High School, at 660 Washington Street in Mishicot! Concessions presented by our Mishicot area nonprofit groups are available beginning one hour prior to the concerts each week! Concerts are held rain or shine from 6:30-8pm. In the event of inclement weather, concerts are moved into the gymnasium at O.H. Schultz Elementary School. Bring a blanket or lawn chair and enjoy wonderful music in the good old Summer Time! See www.michicot.org for concerts.

Cold Country Vines & Wines Summer Concert Series

May – September Saturdays 2:30–5pm summer music is inside our covered arena, rain or shine at E3207 Nuclear Road 3 ½ miles from Lake Michigan. We invite you to sip wine, relax, and enjoy the music. Visit our website ColdCountryWines.com for a listing of all music events.

July 8 & 9	Rock Legend Fest featuring Shy Guys and Rocker
September 16	Harvest Fest featuring Acme Pickers
October 28	Halloween Party with The Shy Guys



In-house-made Cheeses • Imported Cheeses
Artisan Bread • Traditional Dutch Treats
Warm & Friendly Atmosphere

*Fresh brewed coffee and teas
are also available
for takeout and inside consumption*

409 Milwaukee Street, Kewaunee, WI • 920-388-6500

2023 CONCERT EVENTS

Parallel 44 Vineyard & Winery Summer Music

June – August Visit www.parallel44.com for complete list of dates and musicians.

von Stiehl Winery Summer Concert Series A cool Lake Michigan breeze, live music, a beautiful riverside view, a glass of your favorite von Stiehl wine or craft beer from Ahnapée Brewery and you have the recipe for the perfect afternoon. Check von Stiehl's event calendar for more information and band line up. Saturdays we feature a food truck, so please no carry-ins. www.vonstiehl.com

July 1	KLK Trio – 12:30-4pm
July 2	Andy Braun – 1-4pm
July 8	Fork in the Road – 12:30-4pm
July 9	Songa – 1-4pm
July 15	The Kolache Brothers – 12:30-4pm
July 16	Micah Olsan – 1-4pm
July 22	Glas Hamr – 12:30-4pm
July 23	Genevieve Heyward – 1-4pm
July 29	Suzie and the Detonators – 12:30-4pm
July 30	Cherry and Jerry – 1-4pm
August 5	Adam Trask – 12:30-4pm
August 6	Charlie Wiggins – 1-4pm
August 12	Charlie Bucket – 12:30-4pm
August 13	Mockingbird – 1-4pm
August 19	Out of the Blue – 12:30-4pm
August 20	Ten Strings – 1-4pm
August 26	Breakwater Rocks – 12:30-4pm
September 2	Fork in the Road – 12:30-4pm

Al-Vi Lane Farm



Farm Fresh Beef

Jerrod & Cheryl Schleis

920-973-1295 | jerrod.schleis@gmail.com

4728 Schleis Rd, Two Rivers, WI 54241 |  follow us

Located just West of Highway 42 between Kewaunee and Two Rivers

Offering whole, half and
quarters of beef for direct butcher
AND
individual cuts/bundles sold off
the farm.

Contact us through phone, email,
or Facebook to place an order or
for inquiries!

2023 ONGOING EVENTS

Parallel 44 Vineyard & Winery Tours

May – October Visit parallel44.com for more information and to sign up, or call us at 920-388-4400 for more information.

Von Stiehl Winery Tours

Visit vonstiehl.com/events

Cold Country Tour Information

Kewaunee County's newest winery is situated on 16 rolling acres over-looking the East Twin River Valley. To schedule a tour, please call 920-776-1328.

ColdCountryWines.com.

Kewaunee Farmer's Market

Mid June – September Thursday evenings at Clock Corner, Downtown Kewaunee. Call 920-388-4822 for more information.

Mishicot Farmer's Market

May – October Wednesdays at Mishicot Village Hall parking lot on East side.

Algoma Farmer's Market

July – October 9am–Noon at Legion Park. The market will feature children's activities, live music, and weekly events such as a kid's market, health and wellness activities, and learning and education. Visit www.visitalgomawi.com for more information.

Packers Game Day Bus

Are you in Kewaunee the day of a home Green Bay Packers game and wish you could be at the stadium? The Chamber is again arranging transportation to the home games. The bus leaves Algoma approximately 4 hours before kickoff. Pick up sites are Algoma Youth Club, Algoma, Coho Motel and Harbor Lights Lodge, Kewaunee. Ticket price includes coach bus transportation to and from the game. Parking is a short walk from the stadium. Bus leaves promptly one hour after the end of the game. Visit www.kewaunee.org for more information and to reserve your seat!

Tug Ludington Tugboat Tours

Mid May – Mid September Kewaunee Harbor, 920-388-5000

Spring & Fall Fish Run

CD Besadny Fish Facility, Dana Farm, Kewaunee, 920-388-1025

IMCA Stock Car Racing

April – August Sunday nights at the Fairgrounds in Luxemburg, 920-845-2300 or visit www.luxemburgspeedway.com

Biking and Kayaking with Robin

June – August Call Robin Nelson at 920-255-1357 for dates and times.

Kewaunee Public Library

Visit www.kewauneepubliclibrary.org for weekly activities.

PARALLEL 44 | DOOR 44

VINEYARD & WINERY



WWW.44WINERIES.COM
Visit & Shop



10% OFF
YOUR PURCHASE
EXPIRES 12-31-2023
Not redeemable for cash. One coupon per visitor or per day. Must be legal drinking age. Not to be combined with other offers.

Our passion is producing award winning wines from locally grown grapes. Sample our wines, stroll our vineyard, tour our winery, and experience Local!

Explore, Share & Enjoy!

PARALLEL 44 VINEYARD & WINERY
N2185 SLEEPY HOLLOW RD
KEWAUNEE, WI / 920-388-4400
BTW. I-43 & HWY 42. Just east of Green Bay
PARALLEL44.COM

DOOR 44 WINERY
5464 COUNTY ROAD P
STURGEON BAY, WI / 888-932-4400
Corner of HWY 42 & P. Driveway on P
DOOR44WINERY.COM

Nicolet

NATIONAL BANK

Real People. Real Conversations.

519 Main Street
Kewaunee, WI 54216
920.388.2040
NicoletBank.com

MEMBER FDIC

TIMES OF FUTURE PAST

- A FESTIVAL FOR ANY ERA -

HISTORY, SCI FI,
STEAMPUNK, COSPLAY

SCAN ME

Winter Park, Kewaunee WI
June 10-11, 2023

Meet characters - Attend demonstrations -
Explore the marketplace - Enter the Daily
Costume Contest - and more!

2023 CALENDAR OF EVENTS

Please verify dates and times with event sponsor as details may change

March 26 - Cribbage Tournament Wildflower Supper Club 11:30am. Sign up at the Wildflower or message through Facebook. \$40 per 2-person team. 100% payout, door prizes and drink tickets

March 28 - Scams and Banking 1pm Bank of Luxemburg, 630 Main St., Luxemburg. Contact Mari Fager at 920-388-2841 at least one week prior to register

April 1 – Easter Egg Hunt OH Shultz Elementary School, Mishicot

April 2 – MAGIC Annual Banquet Par 5 Resort, Mishicot

April 3 - Cribbage Tournament Wildflower Supper Club 11:30am. Sign up at the Wildflower or message through Facebook. \$40 per 2-person team. 100% payout, door prizes and drink tickets

April 23-29 – National Library Week Join us at Kewaunee Public Library for a week filled with fun activities for all ages! Check out our Facebook page or website for more information: www.kewauneepubliclibrary.org

April 25 – Wildflowers with the Garden Club 7pm Algoma Dugout, 620 Lake St., Algoma. Registration is required one week in advance, please call Jan Tess at 920-255-2546.

April 28 – Kewaunee Rescue Fish Fry 11am-6pm. Drive thru at the ambulance garage on Fifth Street. Enjoy a deep-fried whitefish dinner with your choice of potato, coleslaw, and rye bread. Profits benefit the Kewaunee Rescue Auxiliary and are used to purchase needed equipment.

May 6 – Luncheon and Style Show 11am cocktails, Noon Luncheon, 12:45 style show. Classix Restaurant, ticket purchase required one week ahead of time 920-255-3677 or 720-927-0969

May 12-13 – Mishicot Village Rummage Sale

May 27 – Garden Club Plant Sale Harbor Park Kewaunee

May 27 – Garden Show Lakehaven Hall

June 3 – von Stiehl Steer Roast 11am-4pm

June 9-10 – Kewaunee Citywide Rummage Sale 8am-4pm Participate by having a rummage sale or browsing the town looking for a bargain.

June 9-11 – Lighthouse Festival 10am-Noon on Friday; 10am-4pm Saturday & Sunday. Tour the Kewaunee lighthouse and learn about its history.

June 10-11 – Times of Future Past A festival for any era. Winter Park, Kewaunee. Meet characters, artisan marketplace, costume contest, educational demonstrations, and talks.

June 18 – Kewaunee County Breakfast on the Farm 8am-Noon, Salentine Homestead Dairy, E1669 County Road A, Luxemburg. Enjoy a delicious

2023 CALENDAR OF EVENTS

dairy brunch, farm tours, and fun for the whole family!

June 20 – Dinosaur Dimensions Show 10:30am Holy Rosary School Gym. This is the Kewaunee Public Library's kick-off to the Library Summer Reading Program called "All Together Now!" Join in summer reading challenges and activities. Call 920-388-5015 for more information.

June 23 – 21st Annual Kewaunee FFA Alumni Tractor and Truck Pull 6pm at the Kewaunee Ag Heritage Farm, N2251 Hwy 42 south of Kewaunee.

July 1 – 50th Anniversary Celebration RIO Creek Fly-In & Hangar Dance 7am Pancake/Porkie Breakfast, music & fun!

July 3 – Fireworks at the Shore 4-10:30pm, Old Fashion Fireworks at the Lakeshore sponsored by Kewaunee Area Chamber of Commerce and Brown Fest. Kids activities, food, drinks, and fireworks at dusk. Food provided by Muskrat City.

July 8 – Vintage Snowmobile and Car Show Hosted by Lakeshore Area Vintage Snowmobile Association, Downtown Kewaunee. Registration 8am-Noon. Trophies at 4pm. For more information call Bob at 920-255-4272.

July 13-16 – Kewaunee County Fair Music, food, animals, rides, fun for the whole family! Parade on Sunday July 16th. Visit www.kewauneecountyfair.com for more information.

Kewaunee County's Finest
Open Year-Round



harbor lights lodge



- 33 Deluxe Guest Rooms and Suites
- Computer with Internet in Lobby
- Handicapped Accessible Rooms Available
- Harbor View Rooms with Private Balconies
- In-Room Wireless High Speed Internet Access
- 25-Inch Cable TV
- All Rooms Feature AM/FM Clock, Hairdryer, Coffeemaker, Microwave & Refrigerator
- Ample Boat Parking & Nearby Ramp

211 Milwaukee Street (Hwy. 42), Kewaunee, WI 54216

(920) 388-3700 or 1-800-736-3700

www.harborlightlodge.com harbor@harborlightlodge.com

2023 CALENDAR OF EVENTS

July 14-23 – 41st Annual K/D Salmon Tournament The K/D Salmon Tournament is an amateur sport fishing tournament that runs for ten consecutive days on Lake Michigan off the Kewaunee County/Door County shorelines. The heaviest fish caught wins its angler \$10,000.

July 15 – Alumni Fest Lakehaven Hall Noon-10:30pm. We are a 501(c)3 organization providing an atmosphere for graduates for many generations of this community to get together in friendship in a community celebration. There will be live bands, great food, cold beer and soda. Donations fund this event. Get together with graduates of the past. www.khsgrads.org

August 5 – Mishicot Riverfest Mishicot Village Park. Visit www.mishicot.org for more information.

August 11-13 – Algoma Shanty Days Three fun-filled days with art and craft vendors, great food and live music with a parade at noon on Saturday.

August 19 – 9th Annual Soar on the Shore 11am-4pm Crescent Beach Boardwalk, Algoma. Kite flying event.

August 22 – Fall Fun Fest 5pm Kewaunee County Highway Department. Call Jeanne Dworak at least one week ahead of time for registration at 920-776-1833.

September 15 – Kewaunee Rescue Fish Fry 11am-6pm. Drive thru at the ambulance garage on Fifth Street. Enjoy a deep-fried whitefish dinner with your choice of potato, coleslaw, and rye bread. Profits benefit the Kewaunee Rescue Auxiliary and are used to purchase needed equipment.

September 23 – Zoobilee 10am-4pm Bruemmer Park Zoo. Car show, face painting, food, wagon rides and more!

September 23-24 – Ag Heritage Days 9am-4pm Kewaunee County Fairgrounds, Luxemburg. in Luxemburg.

October 6-8 – Lighthouse Festival 10am-Noon on Friday; 10am-4pm Saturday & Sunday. Tour the Kewaunee lighthouse and learn about its history.



E5427 2nd Rd | Kewaunee
920-251-7450 www.gleninnish.com

2023 CALENDAR OF EVENTS

October 21 – Fur Trading in Kewaunee 1pm Kewaunee Historical Society, Kewaunee. Call Mari Fager 920-388-2841 at least one week ahead of time to register.

October 21 – Mishicot Pumpkin Fest Visit www.mishicot.org for more information.

November 11-12 – Aissen Tree Farm Christmas Open House

November 17-18 - Christkindlmarkt Experience a traditional, centuries old European Christmas Market. Shopping, traditional German meal, and many vendors, Friday 3-9 and Saturday 10-4.

November 17-18 – Kewaunee County Historical Society Bake Sale 10am-4pm. Stop in on your way to Christkindlmarkt or while on the Stroll and enjoy some traditional baked goods!

November 17 – Holiday Parade of Lights Begins in Kewaunee Grade School parking lot at 6:30pm and heads to Lakehaven. Enjoy music and floats and of course, Santa Clause!

November 17-18 and 24-25 – Christmas Stroll 10am-4pm Stroll area businesses for unique gifts and a chance to win a prize at every stop.

December 2 – Mishicot Christmas in the Village For more information visit www.mishicot.org.



Pilsen, WI
WWW.AISSERTREEFARM.COM

KEWAUNEE COUNTY'S LARGEST CHRISTMAS GIFT SHOP ~ OVER 9000SQFT

- OVER 7000 ORNAMENTS
- UNIQUE GIFTS
- ANTIQUES
- FRESH WREATHS, KISSING BALLS, GARLAND, TREES
- INDOOR LIFESIZE GINGERBREAD PLAYHOUSE

UNIQUELY OPEN DAILY 9AM - 7PM

STARTING NOVEMBER 11 THROUGH CHRISTMAS EVE DAY

WE ARE EASY TO FIND! JUST 10 MILES WEST OF KEWAUNEE, RIGHT ON HWY 29
E1105 STATE HWY 29, LUXEMBURG 920-845-5554

DISCOVER COLD COUNTRY WINES



Summer Hours: Open Daily
Mon-Sat 10am-5pm, Sun 12pm-5pm
Winter Hours: Vary
Call ahead or check online



920-776-1328

**E3207 Nuclear Rd
Kewaunee, WI 54216**

coldcountrywines.com

*From Kewaunee: Drive south on
Highway 42 for 9 miles. Turn right
on Nuclear Road for 3.5 miles.
Cold Country is on the left.*

DANA FARM ICE SKATING RINK

The Dana Farm Ice Skating Rink, a project primarily funded with a generous donation from Kewaunee County Farm Technology Days 2017, is an outdoor ice rink that is FREE to use during the months of January and February or as long as the ice is in good condition.

The ice rink, which is located at N3787 Ransom Moore Lane, Kewaunee and adjacent to Winter Park, is typically open to the public seven days a week from the hours of 9am – 8pm and it is lighted for night skating.

Visitors must bring their own skates, rentals are not available. The ice rink is unsupervised, so it is use at your own risk, and the Kewaunee County Promotions & Recreation Department asks that visitors be patient if staff needs to clear snow from the ice.

There is a park shelter with public restrooms that can be used year round, which includes those taking advantage of the 27-hole disc golf course that winds around Winter Park during the warmer months.

To check on current ice conditions at the Dana Farm Ice Skating Rink, call 920-388-7199 and for more information, visit www.kewauneeeco.org look under the Promotions & Recreation Department as well as www.VisitKewauneeCounty.com.



*Rooster's is a favorite
among locals and visitors alike,
stop in for good times with great people!*

**LIVESTREAMING KEWAUNEE STORM
ATHLETIC EVENTS**

**207 ELLIS STREET, DOWNTOWN KEWAUNEE
ROOSTERSBARKEWAUNEE.COM**



WINTER PARK

Winter Park is best known for snow tubing, skiing, snowboarding, and snowshoeing. The park is typically open to the public on the weekends during the months of January and February.

The snow tubing hill features five lanes approximately 450 feet long with a vertical drop of 70 feet. Getting to the top of the hill is easy as riders can hop on a "Magic Carpet", a standing conveyor belt system that transports visitors up with their tubes in approximately two minutes.

Snow tube riders are required to be at least 42" tall for safety reasons.



The skiing/snowboarding area has five runs some over a quarter mile in length with a 160 foot vertical drop with a T-bar lift that brings skiers and snowboarders to the top. There is also a beginner's hill for those just learning the sport that is equipped with a tow rope lift system.

Visitors are also invited to snowshoe around the park's trail system for FREE.

Winter Park offers ski, snowboard and snowshoe equipment rentals and has a warming chalet with concessions, public restrooms, tables, chairs and storage cubbies.

Winter Park also doubles as a 27-hole disc golf course during spring, summer and fall. It's rated eighth in the state by Disc Golf Course Reviews. The scenic course covers the entire park. You'll find a donation tube located at the park for upkeep.



**The park is located at
N3787 Ransom Moore Lane, Kewaunee**

**To check on current conditions, call 920-388-7199
and like Winter Park - Kewaunee County on Facebook.**

Visitors can find park hours and rates for activities online at www.kewauneco.org under the Promotions & Recreation Department as well as www.VisitKewauneeCounty.com.

BESADNY ANADROMOUS FISHERY

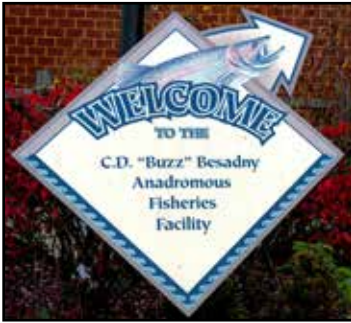

Where Salmon Eggs are Turned Into Salmon

The Wisconsin Department of Natural Resources (WDNR) operates a fish egg collection station near the City of Kewaunee. The WDNR's Besadny Anadromous Fisheries Facility (BAFF) is nestled in a secluded area along a quiet, scenic stretch of the Kewaunee River. Trout and salmon migrating from Lake Michigan are led by flowing water past two underwater viewing windows to a fish ladder - a series of waterfall-like steps - that leads to

six collection ponds. Fish are moved from the ponds through the spawning process in the building and back to the river - upstream of the barrier dam - to continue their upstream migration.

History in the Making

Trout and salmon have been stocked into Lake Michigan since the early 1960's. Prior to the construction of BAFF, WDNR has relied, at least in part, on other agencies for eggs and/or fish of several species or strains to maintain the trout and salmon sport fishery in Wisconsin waters of Lake Michigan. BAFF is

designed to serve as a collection station for trout and salmon eggs but the staff there also hatch and raise both lake sturgeon and spotted musky for stocking into Lake Michigan and Green Bay respectively. Additionally, BAFF provides a scenic place for the general public to observe migrating fish and to learn about fisheries and other WDNR programs through tours and educational programs offered by the facility.



Why We Do the Things We Do

The primary objective of the WDNR trout and salmon stocking program for Lake Michigan is to provide a diverse sport fishery for anglers. Each year WDNR stocks millions of trout and salmon into Lake Michigan tributary streams to provide a put-grow-and-take in the lake and sport fishery in the tributary streams. Since most Wisconsin tributary streams lack the potential to support adequate natural reproduction, adult trout and salmon must be collected each year and spawned. Their progeny are raised in hatcheries and stocked back into the tributaries to complete the cycle.



BESADNY ANADROMOUS FISHERY

When Can We See the Fish Jumping?

BAFF operates from March through December with exact dates dependent upon spawning migrations of the various fish species. For specific days either see our electronic display sign in the building lobby or call the number listed below. Migration times for the spring steelhead occur from early March through early May. The chinook salmon run begins in mid-September and continues through mid-November. The fall coho salmon run occurs from mid-September through late October. Seeforellen brown trout begin to enter the stream by mid-October and continue to run until the river ices up in late December.

Hours of Operation

The Besadny Fisheries Facility is open to the public for viewing every day of the year during daylight hours. Fish are not always present. However, general spawning migration periods are listed above. Please call the number listed below if you need more information. Special group tours are available and can be arranged by calling the Besadny Facility manager at 920-388-1025. Information and educational displays also lead visitors on a self guided tour and provide basic information on trout and salmon life history, facility operation, and other related subjects.

**We look forward to
seeing you in the future!!**



The logo for The Ballerina Restaurant. It features a red flame icon inside a circular frame. Below the icon, the text "THE BALLERINA RESTAURANT" is written in a bold, serif font. Underneath that, in a smaller font, it says "— STEAKS • FISH FRY • SMOKEHOUSE —". At the bottom of the logo, the phone number "920-388-6011" is displayed. To the right of the logo is a white Facebook icon on a black background.

HISTORIC DOWNTOWN WALKING TOUR

Take a tour of Kewaunee's historic downtown area and experience a city vital to Wisconsin's past, present, and future!

Please visit the Kewaunee Historical Society for more information about these landmarks



Grandfather Clock Kewaunee boasts the world's largest grandfather clock at 35' 10", originally built by Svoboda Industries in 1976 for the U.S. Bicentennial Celebration.

Tug Ludington The Ludington, christened the Major Wilbur F. Browder, participated in the D-Day invasion and continued to assist in harbor operations. In 1947, the tug was stationed in Kewaunee by the Army Corps of Engineers.

Railroad Depot Built in the 1890s, the Depot accommodated passenger service from the Green Bay and Western Railroad between Kewaunee and Green Bay; a spur from Kewaunee led to Door County.

Life Saving Station Originally built in 1893, the Life Saving Station was one of many that served as the precursor to U.S. Coast Guard working tirelessly to save lives in a growing shipping industry. The station continued under the Coast Guard until its closure in 1947.

HISTORIC DOWNTOWN WALKING TOUR

Kewaunee Lighthouse As Kewaunee became an increasingly vital port connecting Wisconsin and the Midwest to the Eastern U.S., the Lighthouse served as the centerpiece to assist incoming and outgoing ships.

Priebe Cold Storage (Port O' Call Restaurant) The Priebe Cheese Cold Storage building, built in 1935 replacing the old Crosby and Meyers Cheese House that formerly occupied this site.

Emerald and Dickinson The coal barges, Emerald and Dickinson, sank off the coast of Lake Michigan near Kewaunee on November 17, 1885 leading to the construction of the Life Saving Station.

Light Plant In 1892, a group of citizens requested streetlights from the city council. In 1895, an ordinance was passed to construct an electric light plant. The light plant was finally built in 1908, and Kewaunee got electric lights.

Lakehaven Hall Part of the Hamachek Machine Company established in 1898, included a foundry, planing mill, machine shop and lumber warehouse.

Karsten Hotel In 1858, the Steamboat House was built on the current Karsten Hotel site, serving as a major hub for social activities. On February 14th, 1912, a fire destroyed the building. The hotel is claimed to be home to three spirits: William Karsten, the former owner; Billy Karsten III, his grandson; and Agatha, a maid who had worked and lived at the hotel.

Doctor's Office Considered the oldest doctor's office in Wisconsin, it was built in 1873. Dr. Oliver Martin began practice in Kewaunee on March 2, 1874. It was also the site of the first volunteer-type lending library

Kewaunee Bottling Company (Kewaunee Artisans Center) The Kewaunee Bottling Company aka Pop Shop began in 1919 with one truck and a horse-drawn sled. The company distributed a variety of beers and manufactured Double Cola, Bubble Up, Squirt, Baumeister Root Beer, Orange, Cherry and Cream sodas.

Parkos Mobil This Tudor revival-style Walden Service Station opened in 1931. In 1976, it was sold to Parkos Oil and remains a service station today.



Goodrich Dock The Goodrich boats traveled the Lake Michigan waters in the late 1800s carrying cargo and passengers. Docking in this area, they were near Wanninger's Pea Factory and Seyk's Grain Elevator.



USS Pueblo Between 1941 and 1946, Kewaunee Shipbuilding and Engineering delivered 80 vessels to the U.S. Government. Its most newsworthy ship was the USS Pueblo when, on January 23, 1968, she was captured by the North Koreans; the crew and her captain were accused of espionage.

Maple View Campground

N1267 Norman Rd. Kewaunee, WI
Season: (920) 776-1588 Off Season: (920) 388-2910



Private Spring Fed Lake • 30 Beautiful Shaded Acres



Free Hot Showers • Flush Toilets • Coin Laundry • Water
Sewer • Electric Hookups, 30 & 50 Amp • Sandy Beach
Playground • Horseshoes • Volleyball • Basketball • GaGa Pit
Horse Drawn Wagon Rides

www.mapleviewcampground.com

Follow us on Facebook



MARQUETTE HISTORICAL DISTRICT

The Marquette Historic District is a distinctive residential neighborhood of fine homes located within the heart of Kewaunee. The Marquette Historic District, which is listed in the National Register of Historic Places, consists of forty-three homes. Take a self-guided walking tour on the city streets to experience these showcased homes built in the late 1880's through the early 1900's by some of Kewaunee's most prominent businessmen. Expect to find a variety of Italianate, Second Empire, Queen Anne, Craftsman, Prairie, American Foursquare, and various Period Revival styles of architecture.



Guidebooks are available for purchase at the Chamber Tourist Information Center. This tour is well worth your time!

Kewaunee County Historical Society & Jail Museum

100th Anniversary 1921-2021

50th Anniversary 1970-2020



History Center

217 Ellis Street, Downtown Kewaunee
Open Thurs. and Fri. 10:00am - 4:00pm
(920) 388-0369



Jail Museum

613 Dodge Street, Kewaunee
Open Memorial Day - Labor Day
Thurs - Sun, Noon - 4:00pm



Rhonda Pamperin

- 📞 920.819.1426
- ✉ rhonda@lilacshanty.com
- 🌐 lilacshanty.com
- 📍 Ng003 County Road DK
Luxemburg, WI 54217

MARQUETTE HISTORICAL DISTRICT

- 1) 805 Dodge St
- 2) 324 Center St
- 3) 816 Dodge St
- 4) 822 Dodge St
- 5) 821 Dodge St
- 6) 416 Rose St
- 7) 900 Dodge St
- 8) 903 Dodge St
- 9) 909 Dodge St
- 10) 915 Dodge St
- 11) 921 Dodge St
- 12) 314 Dorelle St
- 13) 1004 Dodge St
- 14) 1003 Dodge St
- 15) 1018 Dodge St
- 16) 1021 Dodge St
- 17) 1102 Dodge St
- 18) 1103 Dodge St
- 19) 1109 Dodge St
- 20) 1112 Dodge St
- 21) 1118 Dodge St
- 22) 1119 Dodge St
- 23) 1203 Dodge St
- 24) 1213 Dodge St
- 25) 1122 Milwaukee St
- 26) 1104 Milwaukee St
- 27) 1026 Milwaukee St
- 28) 1020 Milwaukee St
- 29) 1017 Milwaukee St
- 30) 1012 Milwaukee St
- 31) 1009 Milwaukee St
- 32) 1003 Milwaukee St
- 33) 222 Dorelle St
- 34) 205 Dorelle St
- 35) 922 Milwaukee St
- 36) 916 Milwaukee St
- 37) 908 Milwaukee St
- 38) 210 Rose St
- 39) 204 Rose St
- 40) 205 Rose St
- 41) 820 Milwaukee St
- 42) 815 Milwaukee St
- 43) 804 Milwaukee St
- 44) 803 Milwaukee St

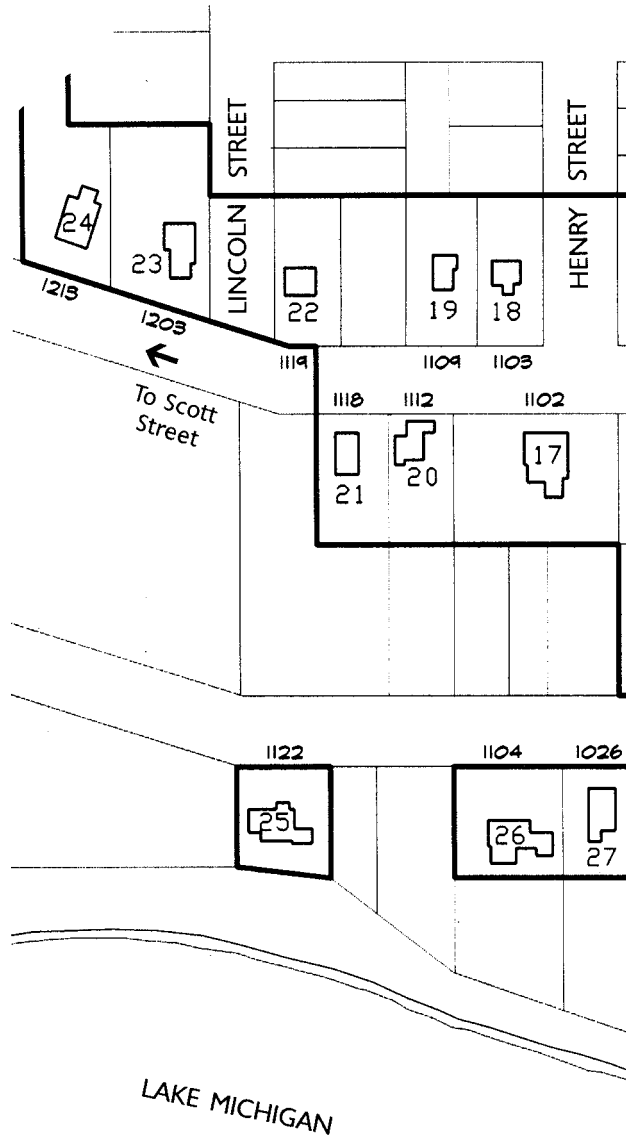

MARQUETTE HISTORICAL DISTRICT

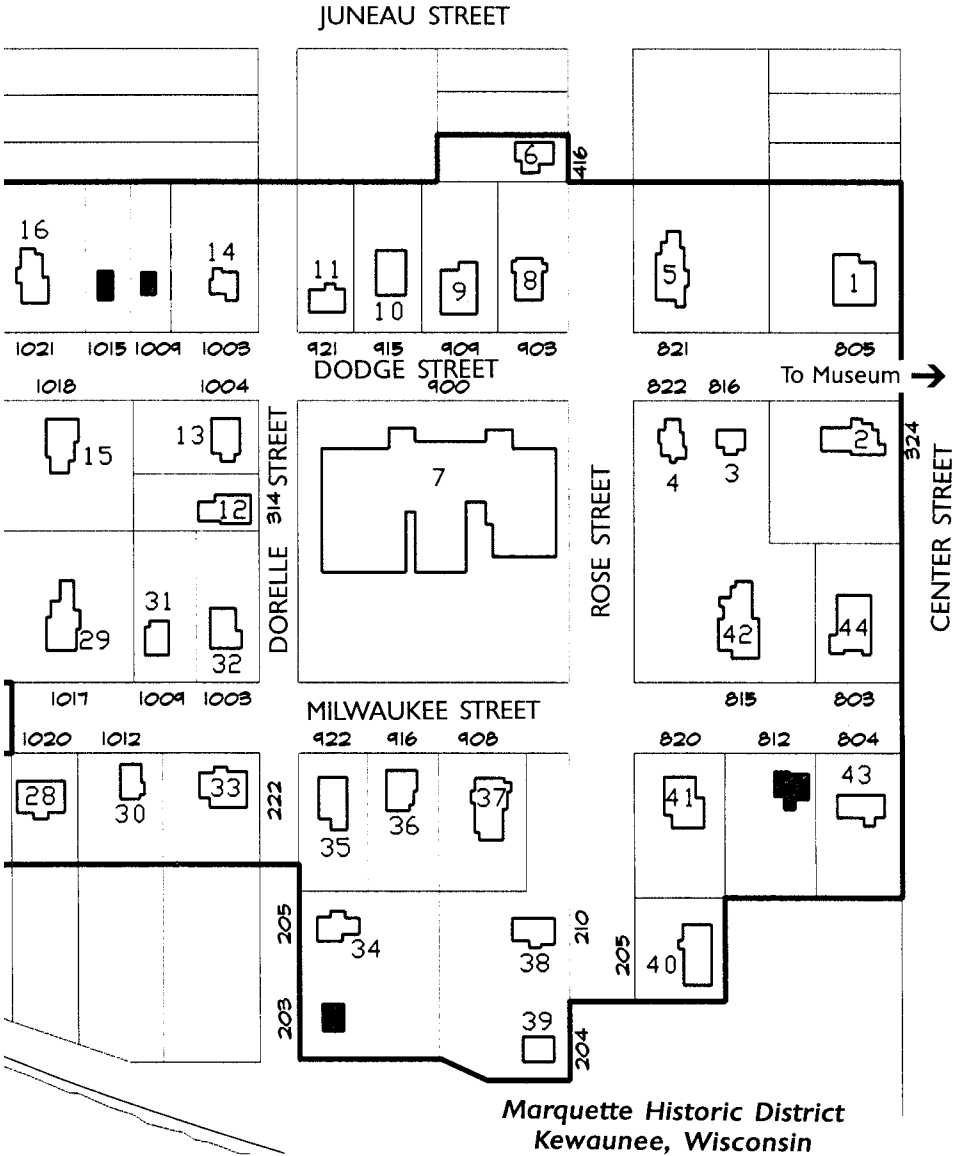

Marquette Historic District
Kewaunee, Wisconsin

KEWAUNEE PARKS



- A - AHNAPEE TRAIL, GRANFATHER CLOCK, FIRE MUSEUM**
- B - MARSH WALK PARKS**
- C - FATHER MARQUETTE**
- D - HARBOR POINT**
- E - HARBOR**
- F - PIONEER**
- G - SELNER**
- H - HANEY**
- I - LIGHTHOUSE / DON & JEAN SMITH MEMORIAL PARK**
- J - KEWAUNEE MEMORIAL & KIEWIG**
- K - BREUMMER (CTY C AND CTY F)**
- L - WINTER (CTY C WEST, LEFT ON CTY F)**

**Contact City Hall
for Pavilions available
for rent:
920-388-5000**

CHAMBER BUSINESSES

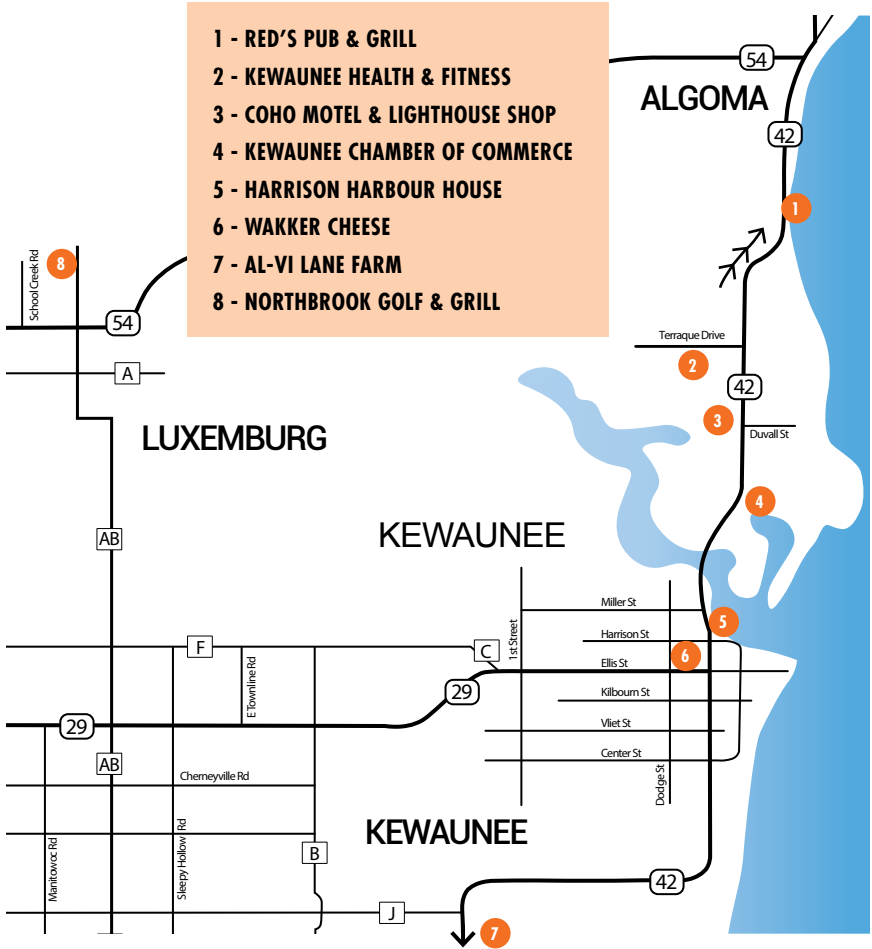

NORMAN GENERAL STORE





Quilt Fabric, Vintage Wares,
Made in Wisconsin Gifts & More.

Hours vary by season. Visit our Facebook page or normangeneralstore.com for current schedule.



**E3296 COUNTY ROAD G
 KEWAUNEE, WI 54216
 920-301-0617 CALL / TEXT**

FESTIVALS

Sponsored by Kewaunee Area Chamber of Commerce

July 3

Old Fashioned FIREWORKS

at the Lakeshore

Sponsored by your Kewaunee Area Chamber and Brown Fest

Monday, July 3, 2023

FOOD • DRINKS

Lakehaven Hall, Kewaunee

Brats, Burgers, Hot Dogs & more starting at 4:00 pm

by Muskrat City Sportsman's Club

Kids Activities and Games 3:00 pm-Dusk

Music 4:00 pm-Dusk

Fireworks begin at dusk



Kewaunee Art Walk

Local artists have painted banner art that will be displayed in downtown Kewaunee from July 3rd through early fall.



Call 920-388-4822 or visit www.Kewaunee.org for more information

No food or beverage carry-ins

FESTIVALS

Sponsored by Kewaunee Area Chamber of Commerce

GREEN BAY PACKERS GAME DAY BUS

The Kewaunee Area Chamber of Commerce is arranging transportation via motorcoach bus to home Packers games for visitors and local residents.

Pick-up Locations:

Coho Motel, Kewaunee

Harbor Lights Lodge, Kewaunee

Algoma Youth Club, Algoma

Bus picks up 4 ¼ hours before game time from Algoma, 4 hours from Kewaunee. Return bus picks up one hour after the game (a few blocks south of Lambeau Field)

For more information, contact 920-388-4822 or 920-388-3565

Reservations can be made at www.kewaunee.org

SPONSORED BY KEWAUNEE AREA CHAMBER OF COMMERCE & A&W

KEWAUNEE AREA CHAMBER OF COMMERCE ANNUAL

Christkindlmarkt

LAKEHAVEN HALL

HOLIDAY MARKET

German Food & Visit with Santa

Friday, November 17, 3–9pm

Holiday Lights Parade 6:30pm

Saturday, November 18, 9am–4pm

KEWAUNEE COUNTY CHRISTMAS STROLL

Visit area shops to win prizes

Friday-Saturday, November 17-18 & 24-25

10am–4pm



KEWAUNEE FABRICATIONS

An Oshkosh Corporation Company

1941 ————— 2023

A PROUD PAST — AN EXCITING FUTURE

**520 Main Street, Kewaunee
920-388-2000**

HARBOR VIEW



CHARTERS LLC
KEWAUNEE, WI

**KEWAUNEE'S PREMIER
FULL SERVICE SALMON
AND TROUT FISHING
CHARTER**

ENJOY A FUN AND EXCITING
FISHING TRIP ON OUR
WELLCRAFT COASTAL.

TRIPS FOR ALL AGES
TO EXPERIENCE THE FUN
OF REELING IN SOME
LAKE MICHIGAN SALMON

BOOK YOUR TRIP TODAY AT HARBORVIEWCHARTERS.NET

42

Take the Scenic Shortcut!

A SCENIC SHORTCUT TO THE PENINSULA AWAITS!

Leave I-43 behind and take in the countryside. Use exit 149, head into downtown Manitowoc and pick up Scenic HWY 42 at Waldo Blvd. Head north and travel the scenic Lake Michigan shoreline through Manitowoc, Two Rivers, Kewaunee and Algoma. This is one of the most beautiful drives in the state of Wisconsin.

MANITOWOC: COAST FOR A WHILE

A coastal destination with a deep maritime history. A place where clean breezes off Lake Michigan keep summers cool and turn the fall season into an explosion of color, and where winter works its magic. Fun for the whole family.

Tour the **Wisconsin Maritime Museum**, a fully restored World War II submarine, operate a steam engine, and time-travel back to a 19th century shipbuilding town—all at the region's only Smithsonian affiliate and largest maritime museum. The **Manitowoc Breakwater Lighthouse** makes for a nice stroll on a summer day, and is a favorite place to take photos.

Travelers on the **Mariners Trail** will be spoiled with beautiful vistas of beaches, parks, forests and the sparkling waters of Lake Michigan. Adding to the scenic landscapes are several trailside gardens and public art pieces. The 6-mile paved pathway traces the shoreline of the Great Lake, connecting the cities of Manitowoc and Two Rivers.

TWO RIVERS: AND THEN I SAW THE LAKE...

Two Rivers is defined by water where the scenic East & West Twin Rivers meet at a sandy point extending into Lake Michigan. **Neshotah Beach** is a beautiful 50 acre groomed sand beach on Lake Michigan with areas for swimming, volleyball, and launching jet skis and kayaks. There are also sports areas, playgrounds, the Rawley Point bike trail, horseshoe pits, four shelters, and picnic areas with tables and grills.

Rogers Street Fishing Village is home to the **Two Rivers North Pier Lighthouse**, the only example of a wood pierhead light surviving on the Upper Great Lakes. Named after one of Manitowoc County's first settlers Peter Rawley, **Rawley Point Lighthouse at Point Beach State Forest** is among the brightest signals on the Great Lakes rising 113 feet above the water.

The **Rawley Point Trail** is a winding, hard-packed limestone pathway from the harbor town of Two Rivers on the shores of Lake Michigan to Point Beach State Forest. The 6-mile, sometimes hilly, trail offers scenic views of the lake, beaches, dunes and forests.

KEWAUNEE: A QUIET & PICTURESQUE COMMUNITY

The **Marquette Historical District**, a distinctive residential neighborhood of fine homes located within the heart of Kewaunee, will greet you upon entrance to the city. Take a self-guided walking tour of the 43 homes built in this National Register of Historic Places.

Kewaunee Harbor Park, offers visitors a newly renovated seawall and boardwalk, creating a walking path from the historical Kewaunee Lighthouse to the Ahnapee State Trail. Along the seawall is the **Tug Ludington**, one of only five ships still afloat that participated in the D-Day invasion at Normandy Beach. Across the street look for the world's tallest **Grandfather Clock** and the **Fire Museum**.

The **Kewaunee Pierhead Lighthouse** is a beloved community icon and a reminder of the local maritime history shared by the early settlers, shipper-merchants, and recreational enthusiasts of today. **Selner Park Beach** offers the best view of Lake Michigan, the pier and lighthouse and is frequently used by artists for inspiration. The park offers benches, picnic tables, grills, and a playground for pure relaxation and family enjoyment.

ALGOMA: CRESCENT BEACH AND A MILLION DOLLAR VIEW

When you arrive in Algoma, it's hard to miss the gorgeous ½ mile **Crescent Beach and Boardwalk**. Take advantage of the view at one of the many picnic tables and benches that overlook the azure blue waters.

Algoma's downtown is dotted with shops, galleries, and eateries all within walking distance. Take the **River Walk** to stroll the **Ahnapee River** and watch the charter boats and kayaks come in and out of the harbor. The new **Ahnapee State Trail** trailhead is only a few blocks west on the corner of CTY S & 6th St.

In 2007 ten historic downtown buildings were painted with murals reflecting Algoma's culture, advertising, and business past. Pick up the **Historic Algoma Walking Tour** brochure for a self guided tour of buildings and murals.

Originally a square white wooden tower structure built in 1893, the iconic red lighthouse was established in 1908. Individual light keepers worked until it was automated in 1973. Sunrise to sunset, the **Algoma Pierhead Lighthouse** provides spectacular photo opportunities.

scenichwy42.com



Manitowoc

Worth the time. Enjoy the view. Take the drive, on 42.

Algoma

Kewaunee

Lake Michigan

Two Rivers

Kewaunee Marina

Located at the Highway 42 Bridge & the Kewaunee Harbor



Photo courtesy of Brian Huben Photography

100-Slip Full-Service Marina

Daily, Weekly & Seasonal Dockage Available

Clean, Private Showers & Restrooms

Fish Cleaning Station

Fuel Dock • Marina Sanitation Pump

Gas Grills • TV, Weather Channel & Internet Access

Campground Sites (Full hookup & primitives)

Boat Trailer Storage Area

Public Boat Launch Facility

123 N.Main Street, P.O.Box 256, Kewaunee, WI 54216

(920) 388-3300

marina@cityofkewaunee.org | www.cityofkewaunee.org

CHARTER FISHING

Kewaunee, WI is home to some of the best King Salmon and Trout fishing in the Midwest. Kewaunee is located on the Northwestern shore of Lake Michigan. Here you will find some of the most knowledgeable charter captains with up-to-date vessels with many amenities. Booking a charter out of Kewaunee will offer you many opportunities to potentially target various species of fish. Examples of fish you may be able to catch are King Salmon, Coho Salmon, Steelhead/Rainbow Trout, Brown Trout and Lake Trout.

Kewaunee is known for producing large numbers of big fish. Charter fishing season generally runs from May to the beginning of October. The boat landing and fish cleaning facilities allow you to bring your own boat to enjoy the fishing experience.

When booking a charter fishing trip, Kewaunee also offers you an opportunity to enjoy many other sites and accommodations. From beautiful campgrounds, concerts in the park, farmers markets and winery tours. Visitors also love seeing the WWII Tug Ludington, taking a lighthouse tour, and viewing the world's largest grandfather clock.

If you are looking to enjoy a great fishing experience, consider booking a charter fishing trip in Kewaunee with a Captain today!

Home Wrecker Sport Fishing Charter



**Fish aboard the HOMEWRECKER,
a 40ft Egg Harbor yacht out of the port of Kewaunee, WI
Call Captain Roy at 920-536-0080**

AREA ATTRACTIONS

The Anadromous Fish Facility In Fall and Spring, make sure you stop by to watch trout and salmon struggle up the fish ladders into special holding tanks for spawning. This facility is run by the Department of Natural Resources. If you stop by on the right day, you will see DNR personnel stripping eggs for the hatchery in the facility. Take a look at the underwater process from a window installed by the Algoma-Kewaunee Great Lakes Sports Fishermen. You also might want to adventure on one of the trails along the river. To get to the facility take Hwy. 29 west, turn right on County C to County F, turn left past Bruemmer Park then turn right on Ransom Moore Lane.

Ahnapee State Trail A “rails to trails” conversion has removed the tracks on this 30-mile trail that connects Kewaunee, Luxemburg, Casco, Algoma and Sturgeon Bay. During spring, summer, and fall; hikers, bikers, horseback riders, and horse-drawn carts and wagons share the trail. In winter, cross country skiers and snowmobilers whisk across its frosty surface. For trail condition reports and further information about county events, call 920-388-7199 or for general information, visit: www.ahnapeestatetrail.com or call 920-388-0444.

Golfing Experience golfing at its best. Kewaunee area offers 3 different beautifully landscaped golf courses. Located on Hwy. 42 between Kewaunee and Algoma is Alaskan Golf Course. This golf course offers 9 holes of golf. Call 920-388-3940 for reservations. Nestled in the heart of Luxemburg, is Northbrook Golf & Grill. Northbrook Golf & Grill is a 4.5 Star course offering 18 holes of golf. Call 920-845-2383. Par 5 Resort located in Mishicot offers 45 holes of challenging golf (featuring the 18 hole links course of The National and the skillfully landscaped parkland-style of Fox Creek 27 hole course). Call 920-755-4000 for reservations.

Harbor Park Stop for a quiet afternoon, pack a picnic lunch, pull up a table, and enjoy the Kewaunee ambiance. Watch the harbor for jet skiers, fishermen, and sailboats ready to enjoy the beautiful Lake Michigan water. On Sundays in summer, Harbor Park is the site of Music in the Park. Pull up a lawn chair and experience some of the best music on the lakeshore.

Heritage Farm Located just south of Kewaunee at N2251 State Highway 42, is the home of Agricultural Heritage and Resources; a not-for-profit association committed to preserving agriculture’s diverse heritage and promoting its future.



Outdoor Harbor-Side Dining
Enjoy daily food & drink specials, deck & flat screen TV's

Lunch Served All Day
Dinner Menu starting at 4pm

Summer Hours:
Memorial Day thru mid-October Open 7 days/week at 11am
Winter Hours: Open Thurs, Fri, Sat at 11 am

Port O'Call 310 Milwaukee Street, Kewaunee • 920-388-4883

AREA ATTRACTIONS

Kewaunee County Bruemmer Park Located about 2 miles west of Kewaunee where Cty C intersects with Cty F. Visitors can enjoy a relaxing day with family and friends. The park features a small zoo with animals that include Nigerian dwarf goats, arctic foxes, bobcats, Barbados blackbelly sheep, peacocks and deer. The park also features a large playground and several shelters for family picnics and parties. Call the Promotion & Recreation Office at 920-388-0444 to reserve a shelter for special events.

Kewaunee County Historical Society Center "If you can't find grandma, you can find her here." Extensive Kewaunee county business and family history, including newspaper clippings, scrapbooks, audio interviews; also 32,000 photos on file. Museum type displays. Children's area. Located at 217 Ellis St., Kewaunee. Open Thursday and Friday 10am-4pm. For more information call 920-388-0369.

Kewaunee Historic Jail Museum Built in 1876 as the sheriff's residence and county jail. Three floors of local history includes a life size basswood statuary of Father Marquette's 1674 landing in Kewaunee, a 5'x6' hand carved diorama of Custer's last stand, and a model of the U.S.S. Pueblo, an electronic ship built and launched in Kewaunee in 1944 and captured in 1968 by the North Koreans. Located at 613 Dodge St., Kewaunee. Open Noon-4pm Thursday – Sunday. For more information call 920-388-7176.

Kewaunee Fire Department "May we display commitment through courage, compassion and camaraderie." The KFDAL is honoring the current and past members of the Kewaunee Fire Department with the Fire Museum. The museum houses 4 of the first 5 pieces of equipment that the Kewaunee Fire Department started with in 1900. The museum is possible through the many donations that community members have donated towards this project.

Kewaunee Tourist Information Center & Chamber of Commerce Located over the bridge on the north side of Kewaunee. Stop in to gather information on more than 100 local businesses in the Kewaunee area. During the summer the Chamber is open daily from 9am-4pm. Ask our knowledgeable volunteers any questions you have about the area. You will also find Wisconsin road maps and information about Wisconsin. We can't wait to assist you.

Kewaunee's Victorian Pierhead Lighthouse Fully operational year-round, with both a main light and a fog signal. Visitors may walk out to the end of the pier and view the exterior of the lighthouse. See page 36-37 for details.



CLOTHING • DECOR • BEEF • TANNING
E1474 Hwy 29, Luxemburg, WI 54217



KEWAUNEE COUNTY
Everything Grows Better Here
VisitKewauneeCounty.com

AREA ATTRACTIONS

Kewaunee Winter Park See page 13 for more details.

Pioneer and Selner Park Just one block from Kewaunee's downtown area, the parks feature public beaches and swimming areas. Pioneer Park is located at the east end of Kilbourn Street, across from the Vollrath Company. It includes a shaded grassy area for picnics, swings and teeter-totters for children, and a sandy beach. Selner Park is just a block south. Swimming is at one's own risk with no lifeguard available. Two other parks are on the water, north of the bridge. Father Marquette Memorial Park sits at the foot of the hill on Lakeshore Drive, with a kitchen and restroom facility. Harbor Point Park has grills and a picnic area with a great view of the harbor.

Riverview ATV Park 20 miles of trails designed for those who love an adventure on their ATV, UTV or dirt bike. The park is open early May through mid-November. Helmets and a valid WI registration are required. You'll find a donation tube located at the park for upkeep. The park also has 3-miles of mountain bike trails. More information on park rules and regulations can be found on VisitKewauneeCounty.com or by calling the Promotion & Recreation Office at 920-388-0444.

The Shrine of Our Lady of Good Help Known as "The Chapel" by the local inhabitants, the Shrine of Our Lady of Good Help is built directly over the site where Mary "The Queen of Heaven" appeared to Adele Brise, a young Belgian immigrant woman, in October of 1859, one year after the Marian apparitions occurred at Lourdes. The Shrine of Our Lady of Good Help is located on 6 acres of peaceful farmland just 15 miles Northwest of Kewaunee in Champion, WI. The Shrine of Our Lady of Good Help is the first and only Marian shrine in the United States that is on the site of an approved apparition of the Blessed Virgin Mary.



THE NATIONAL SHRINE OF
OUR LADY OF GOOD HELP

You are invited to come to the Shrine of Our Lady of Good Help. For over 150 years the faithful have come to this hallowed site seeking the intercession of the Blessed Virgin Mary.

Our Lady of Good Help at Champion, WI is the only site in the United States of an approved apparition of the Blessed Virgin Mary.

920-866-2571
4047 Chapel Drive, New Franken, WI 54229

www.championshrine.org



TUG LUDINGTON



Made for WWII, the Tug Ludington was built at Jacobson Shipyard in Oyster Bay, New York. In February of 1943 the Keel was laid and the tug was finally finished in October of that same year.

The U.S. Army accepted and christened the tug "Major Wilbur F. Browder" and designated the tug LT-4. The tug's armament consisted of two 50 caliber machine guns mounted above the chartroom and pilothouse.

The tug participated in the D-Day invasion of Normandy, towing ammunition barges across the English Channel. After Normandy it traveled to Cherbourg, France to assist in harbor operations until being sent to Plymouth, England until the end of the war. After the war, it joined the U.S. Army Transportation Corps and returned to Norfolk, Virginia where it continued service along the eastern seaboard.

In 1947, the Corps Of Engineers transferred the tug to Kewaunee, WI and then renamed it the "Tug Ludington". While in Kewaunee it was used in the construction and maintenance of many harbors on the Great Lakes. The Tug has towed a wide variety of floating equipment. It is estimated that the Tug has hauled over 1 million tons of cargo.

The Tug now rests in Harbor Park in downtown Kewaunee and is open to visitors from June until Labor Day. The Tug is registered in the National and State Register of Historic Places.

For tour information and questions, call Kewaunee City Hall at 920-388-5000.



Kewaunee
Health&Fitness

Your Local Non-profit Fitness Center

www.kewauneefitness.org
160 Terraqua Drive
Kewaunee, WI 54216
920-388-4961

Open 24/7 with Membership

Free Fitness & Yoga Classes for Members

Indoor Pool / Hot Tub / Walking Track

Weight Training & Cardio

Basketball, Pickleball

Swimming Lessons

KEWAUNEE FIRE DEPARTMENT

Earliest records reveal that Kewaunee's first Fire Department was organized on March 20, 1870. The department consisted of two groups called Fire Company No. 1 and Hook and Ladder Company No. 1. Equipment used by the firemen at the time were buckets, axes, shovels and ladders. That same year, the City of Kewaunee



purchased a used "Hand Tub" pumping engine from the City of Milwaukee. The "Hand-Tub" was built as the #266 in 1845 by W.C. Hunneman & Co. of Boston. In 1884 a new hand fire engine arrived from New York. In 1898 both volunteer organizations, the Fire Company and the Hook and Ladder Company of Kewaunee, sent notice to the common council of being dissolved, leaving the city without any organization to man the fire apparatus in the event of fire. The mayor appointed thirty able bodied men to act as a temporary fire department. The city quickly authorized the purchase of a new American Steam Fire Engine from New York, followed by an ordinance establishing and regulating the Kewaunee Fire Department.

Today, the fire department has grown with manpower and equipment to offer fire protection to a 60 square mile area in Kewaunee County, with an average population of approximately 5000 people. The fire protection territory includes the City of Kewaunee, Townships of West Kewaunee, Pierce, Casco and the Kewaunee Power Station. The fire department has eight pieces of motorized fire apparatus available and 38 firefighters who carry radio pagers to be notified in the case of a fire.

The fire department museum is a newly constructed building show piece where historical antique fire apparatus is on display. Fire department history is available for public viewing as wall mounted pictures, antique fire apparatus and equipment are there to see. Taking us back into time is the actual 1845 "Hand-Tub" pumping engine purchased from the City of Milwaukee, the original 1884 hand pumper, a 1908 hand drawn wheeled Hose Cart, and a 1927 American LaFrance pumping engine, still in working condition. The museum is located next to the giant Grandfather Clock and Pavilion in downtown Kewaunee.

The fire department museum is a newly constructed building show piece where historical antique fire apparatus is on display. Fire department history is available for public viewing as wall mounted pictures, antique fire apparatus and equipment are there to see. Taking us back into time is the actual 1845 "Hand-Tub" pumping engine purchased from the City of Milwaukee, the original 1884 hand pumper,

a 1908 hand drawn wheeled Hose Cart, and a 1927 American LaFrance pumping engine, still in working condition. The museum is located next to the giant Grandfather Clock and Pavilion in downtown Kewaunee.



GRANDFATHER CLOCK



The 35' 10" tall grandfather clock in Kewaunee was built in 1976 (bi-centennial) by Svoboda Industries as a hallmark of their business and a gift to the people of Kewaunee. It was built by Jake Schlies with the help of his son, Rodney. In 1984, a new bridge was built in Kewaunee and Svoboda would move its business and the clock to their new Top of the Hill Shop located on Hwy 42 on the northeast edge of Kewaunee. Svoboda's closed the shop and the clock stayed behind and was neglected for more than a decade before selling the property to the Kewaunee County Sherriff's Department in 2013. The clock would now be forced to relocate or be dismantled permanently since the Sherriff's Department planned on using the building for storage. This created a whirlwind of excitement since other cities had interest in taking the clock out of Kewaunee to be restored and used.

Jason Jelinek began a grass root movement using local news outlets and social media to garner attention and support to save a historic piece of Kewaunee, but also a true Americana road side attraction. With full support of Sherriff Matt Joski and soon after Mayor John Blaha, approval to move the clock to its new home at the corner of Miller Street and Hwy 42/Milwaukee Street at the head of the Anhapee Trail was unanimously voted for by the city council in March 2013.

The clock was dismantled in June 2013 for restoration. The body, which was mostly made of redwood, was rotted and replaced with marine grade plywood. A new footing was poured and the steel I-beam backbone inside the clock had extra support struts welded in for bolting to the footing. The ornate clock head was restored through the winter mainly by Dale (Whitey) Vandermoss and his brother, Mike Vandermoss, whom recreated some of the large spindles, coved and crowned moldings by hand. While the outside was being repaired, the German made motors of the clock were looked over by Hacker Berkovitz and made sure they were all keeping time.

On August 27, 2014, the clock body and head were raised in its current home downtown Kewaunee facing the harbor. It would stand alone through the winter of 2014/2015. On May 1, 2015, two pavilion roofs were erected off of each backside of the clock. One running north and south, the other east and west.

On July 30th at 1:00 P.M. the clock was officially started and has been keeping perfect time since. As of December 5, 2015, a sound system was donated and chimes along with music for the seasons can be heard on the quarter, half, and full hours.

All funding to move and restore the clock was provided by donations from local citizens. A true testament to the attachment locals had with the icon. Over \$30,000 was raised and funds continue to support the beautification of the Anhapee Trail head area as well as general maintenance, signage, and electricity. There are many local craftsmen and women, construction companies, including Merten's Construction and Concrete, Schlies Construction and Remodeling, Scott's Industrial Coatings, and Northern Sound and Video, government officials and supporters that deserve a great amount of thanks for the volunteer work that was given so graciously! Thank you all so much! This is the world's Tallest Grandfather Clock!

KEWAUNEE PIERHEAD LIGHTHOUSE



Imagine thick blankets of fog covering the entrance to the harbor, so thick that people could not see their hand in front of them. These foggy conditions along Kewaunee's shore could make boat travel dangerous. Over 1,000 shipwrecks have occurred on Lake Michigan, with some of those being just outside the Kewaunee Harbor.

In 1854 the Wisconsin legislature called for a lighthouse at or near Kewaunee to improve the safety of the harbor and steamships. A full plan to improve the harbor was not put into place until the 1880s.

In 1891, a pair of range lights were installed that helped guide people in from the fog. The next year, construction of the piers and dredging of the river began. There was an elevated catwalk where the lighthouse keeper would enter the lighthouse. The catwalk ran the length of the pier and was used to help keep the lighthouse keeper safe from fierce storms.

In 1909, a diaphone fog signal horn was installed in the front range light. Also at this time, a large fog signal building was built in front of the lighthouse. This addition contained the steam power for the fog signal and doubled as housing for the keeper as he kept watch on long, foggy nights. Prior to the horn, it is said that keepers would walk to the end of the pier and banged boards to warn sailors. A 70 foot steel range light tower was added in 1912.

In 1931, the front range lights were eliminated and a new 45 foot focal plane was constructed on the roof of the 1909 fog horn addition. It is thought that the old fifth order Fresnel lenses were moved into the new tower at this time.

Between 1931 and 2017, there were very few major changes. The catwalk was removed and the door was moved to pier level. In 1981 the light was automated by an electric four-bulb changer. The diaphone fog signal was also removed from the tower in 1981. In 1972, Kewaunee native James Lipsky recorded 31 minutes of the foghorn's unique sound. Today, the recording is enshrined in the Library of Congress's National Recording Registry. The recording can also be found on YouTube at www.youtube.com/watch?v=QrMAyQF7JNl.

Still serving as a functioning lighthouse, the City of Kewaunee received ownership from the National Park Service in 2011. In 2015, the City was awarded a state grant to be used toward the repair of the harbor seawall and restoration of the lighthouse. The main focus was to protect the structure from the elements and curtail further damage.

In 2017, a number of projects on the Lighthouse were completed. The asphalt roof was replaced with a new metal roof system. Rotted roof sheathing was replaced and a complete ice and water shield synthetic layer was laid. Along with the extensive roof repairs, exterior wood elements were stripped of their paint, repaired or replaced if needed, then primed and painted. Corrugated metal

KEWAUNEE PIERHEAD LIGHTHOUSE

siding on the tower exterior was replaced with fiber/cement board siding to give the structure a cleaner, more uniform look. Plywood and plexi-glass enclosures on window openings were removed, allowing more light into the interior and new aluminum storm windows were installed to keep the elements out. The existing window units remain in place, protected from further deterioration for a future restoration project.

In 2018, a historic walking tour was established featuring the Lighthouse. The Don and Jean Smith Lighthouse Park was developed providing space for donor pavers and the memorial anchor commemorating the sinking of the Emerald and Dickinson. The lead paint and asbestos was removed from the interior of the lighthouse.

On June 6, 2019, the Fresnel Lens dating back to 1891 was removed and replaced with an LED light by the US Coast Guard. The lens now resides in a handcrafted display case built by Dan Vogel located at the Kewaunee County Historical Society Building.

In the spring of 2020, a custom made historic replica entrance door costing \$11,689.00 was installed. It is the original Rock Garden Green with polycarbonate windows. A new threshold was also fashioned to accommodate the door.

The outside entrance platform was extended in 2021 to allow for safer entrance and exit of the lighthouse. Additional railings were installed inside the lighthouse for safer transitions in some of the laddered areas. To help complete the walking tour, the area from the Tug Ludington to the Lighthouse was connected with a crushed limestone path.

Plans for 2022 are on hold due to the anticipation of being included on the National Historic Register.

Kewaunee's square lighthouse, resembling the Holland Lighthouse, is white with a red roof. It is steel frame construction and covered in ¼ inch steel plate. The tower is 43 feet high and there are currently no living quarters in the house. The lighthouse is located on the south pier and on the north pier is a navigation marker.

For more information, events, photos, or to support the preservation of the Kewaunee Pierhead Lighthouse, please visit www.kewauneepierheadlighthouse.org.



Located downtown Kewaunee - 222 Ellis St.

We specialize in adorable and affordable women's clothing and accessories.

Casual to special occasion wear.

Private parties available.



RAISE YOUR GLASS TO KEWAUNEE COUNTY WINERIES

What makes Kewaunee County's wines some of the best in Midwest? Is it the fact that the average rainfall is within one inch of Bordeaux, France? Or that the hours of daylight are the same as Tuscany, Italy? Or is it the cool waters of Lake Michigan during the summer? Or is it the perfect soil for growing the many varieties of grapes?

The answer... YES! Kewaunee County, and the entire northeastern Wisconsin area is part of the Wisconsin Ledge, which is an American Viticultural Area (AVA) since 2012. The Wisconsin Ledge is the third AVA designation in the State.



The history of wineries in Kewaunee County begins with von Stiehl Winery in Algoma. In 1967, Dr. Stiehl opened the first winery in the state and produced his wines from Door County cherries and apples. Doc Stiehl sold the winery to Bill and Sandy Schmilg in 1981. At that time, the winery produces about 5,000 gallons of wine a year with 90% of it cherry.

In 2003, Bill and Sandy sold the winery to their sons, Aric and Brad. Today, fifty years later, von Stiehl Winery produces forty grape and fruit wines. The latest technology is used in producing over 75,000 gallons of wine, while still paying attention to detail, just as Doc did in the early days. Today, you can take a tour of the winery, sip a glass of wine on the three-tier terrace over looking the Algoma lighthouse, take part in the many pairing events throughout the year and annually in September, celebrate with us at the Wet Whistle Wine Fest and take part in the Grape Stomp!

What started as a dream for two newlyweds on their California honeymoon in 1994 has turned into a pioneering vineyard and winery in the heart of Kewaunee County since 2005. Steve and Maria Johnson, while sitting in the middle of a vineyard turned to each other and said, "Why don't we do the same thing back home in Wisconsin?" At that time, this notion of pioneering a world class wine region in the heart of the "Frozen Tundra" seemed like an impossibility to most everyone.

Since that time, Steve, Maria and their three children have spent the last 16 years growing grapes and making wines that are winning international acclaim. Our namesake is also our actual geographic location, Parallel 44 or 44 degrees North Latitude. Follow this same line of latitude and you would find yourself walking



RAISE YOUR GLASS TO KEWAUNEE COUNTY WINERIES

through vineyards of Bordeaux, France and Tuscany, Italy. This means you will find the same perfect grape growing conditions (growing degree days, length of daylight and precipitation) here in Kewaunee County.

We invite you to walk the vineyards, take a tour, or relax on the patio overlooking our 10 acre vineyard. At Parallel 44 you will learn, enjoy, and experience why we are the largest producer of "Wisconsin Ledge" Wines in the state. Virtually every wine you taste is "Wisconsin" from ground to glass. Become a wine pioneer with us and immerse yourself with wines and stories that are world class and distinctly and proudly Wisconsin!



The newest winery in Kewaunee County is Cold Country Vines & Wines, which is located four miles from Lake Michigan, perched along the edge of the beautiful East Twin River Valley. Jay Stoeger grew up helping his grandparents and his uncles grow grapes and other fruit, much of it for wine in the Marinette/Peshtigo area. Concord grapes were the most cold hardy, but even those would only produce a crop about three out of every five years. Most of the other varieties grown back then were lucky to produce a crop one year out of every five. Sadly, Jay could only dream about growing grapes and making wine. That is until the late 1990's when a Wisconsin native, Elmer Swenson, revolutionized grape growing in the Upper Midwest and other cold and short-seasoned regions. He started cross breeding and developing grape varieties that would not only survive the cold Wisconsin winters, but would also make a great wine.

Once Jay became aware of these new, cold hardy grapes, his dream could finally become reality. Since Jay's wife Kay shared his passion for wine, it didn't take much convincing to get her to agree to start planting grapes and planning the conversion of their horse barn into a winery. Today, it stands beautifully in the center of their 16-acre vineyard.



Jay and Kay invite you to join them in a toast to the beginning of a new era of fine Cold Country Wines – born from a dream; nurtured by a passion; brought to fruition by commitment to producing the finest wines with the distinctiveness that can only be derived from exceptional varieties of cold climate cultivars.

CARTER'S COLLISION

Auto Body/Collision Repair
All Makes and Models
All Insurance Welcome

Chris & Erin Carter
Owners

920-388-2950 Shop
carterscollision306@gmail.com

N2788 County Road B
Kewaunee, WI 54216

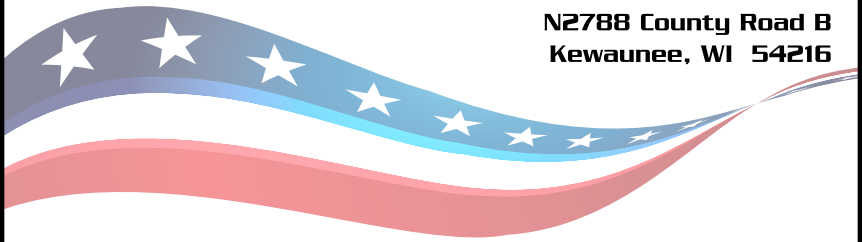

This team is 5★ Rated
by previous clients



KatieRabbit's

This and that
for your home



CHAMBER MEMBER BUSINESS DIRECTORY

920 area code unless specified elsewhere

Emergency 911

Information

Kewaunee Area Chamber of Commerce.	388-4822
Kewaunee Co. Parks & Rec Dept.	388-0444
Hotline	388-7199
Kewaunee Co. Economic Development Corp.	255-1661

Schools

Kewaunee Grade /Middle School	388-2458
Kewaunee High School.	388-2951
Kewaunee Superintendent	388-3230
Holy Rosary Catholic School	388-2285
NWTC	845-5945

Library

Kewaunee Public Library.	388-5015
----------------------------------	----------

Local Government

Kewaunee City Hall	388-5000
Kewaunee Fire Department.	388-5006
Kewaunee Police Department	388-5010
Kewaunee Rescue Squad	388-5000
Kewaunee Sheriffs Department	388-3100
Kewaunee Street Department	388-5002
Kewaunee Water & Sewer Dept.	388-5013
Kewaunee County Courthouse	388-7133

Churches

Community Congregational Church.	388-2719
Holy Rosary Catholic Church	388-4321
Immanuel Ev. Lutheran Church.	388-2592
Lakeshore Baptist Church	606-6901

AGRIBUSINESS

Alpaca to Apparel.	536-1394
Pagel's Ponderosa	388-3333

APPAREL/BOUTIQUE

Alpaca to Apparel.	536-1394
Dalli Moo	680-3344
Lighthouse Gift Shop	388-3565
Pretty Please Boutique	333-3601

APPLIANCES

Harv's Electric	388-3699
---------------------------	----------

ART GALLERIES/SCHOOLS

Kewaunee Artisan Center	304-8018
-----------------------------------	----------

AUTO SALES AND REPAIRS

BlaHa Body Shop.	388-2730
Bob's Auto Parts	388-3024
Carter's Collision	388-2950
Jorns Chevrolet	388-0520

BANQUET/MEETING FACILITIES

Agricultural Heritage and Resource Inc.	388-0604
Lakehaven Hall	255-3328
Northbrook Golf & Grill.	845-2306

BAKERIES

The Bakery Bar	388-0268
Piggly Wiggly - Kewaunee.	388-2311

BREWERY

Ahnapee Brewery	785-0822
---------------------------	----------

CAMPING

Kewaunee Marina	388-3300
Kewaunee RV & Campground LLC	388-4851
Maple View Campground	776-1588

CHARTER FISHING BOATS

Andrew LaFond Charters	388-0577
Fishin' Again Charters.	304-0216
Harbor View Charters	217-3776
Home Wrecker	536-0080
King Addiction Charters.	362-0824
Predator	606-3733



**Kewaunee County
Economic Development
Corporation**

Find out how to start or grow
your business here: KCEDC.org

CHAMBER MEMBER BUSINESS DIRECTORY

920 area code unless specified elsewhere

CHILDCARE

Holy Rosary Childcare 388-2285

CHRISTMAS TREE FARM

Aissen Tree Farm 845-5554

CLEANING SERVICES

Team Clean 255-5975

DENTISTRY

Letter/Sperber Dentistry 388-5200

DISTRIBUTORS

Flanigan Distributors 743-2036

DAIRY/CHEESE

Pagel's Ponderosa 388-3333

Ron's Cheese 845-5330

Wakker Cheese 388-6500

ELECTRICAL SERVICES

Harv's Electric 388-3699

FINANCIAL INSTITUTIONS/INVESTORS

Equitable Advisors 388-2706

Bank of Luxemburg 388-2111

Algoma 487-5288

Luxemburg 845-2345

Nicolet National Bank 388-2040

Algoma 487-3421

Luxemburg 845-1005

FISH MARKETS

LaFonds Fish Market 388-0577

FUNERAL HOME

Kinnard Funeral Home 888-926-3660

FURNITURE/FLOORING

McMahon's of Luxemburg 845-2341

Wiesner & Massart Furniture 837-7414

GARDEN CLUB

Kewaunee County Garden Club 680-5384



TEAM CLEAN

TOUGHER THAN DIRT!

COMMERCIAL - BUSINESS - RESIDENTIAL

WINDOWS - CARPETS - FLOORS

920 - 255 - 5975

117 Ellis St Kewaunee

CHAMBER MEMBER BUSINESS DIRECTORY

920 area code unless specified elsewhere

GAS STATIONS/CONVENIENCE STORES

Harbor Express 388-2254

GOLF COURSES/OUTDOOR REC

Alaskan Golf Club 388-3940

Bay Lake ATV Club 737-3462

Northbrook Golf & Grill 845-2383

GROCERY STORES

Glenn Innish Farm 251-7450

Piggly Wiggly - Kewaunee 388-2311

HEALTH SERVICES

Bellin Health 388-4640

Kewaunee Health & Fitness 388-4961

Lakeshore Vision Center Kewaunee 388-2020
 Algoma 487-2020

Prevea Health 272-1008

HOME CARE

Jay's Legacy Home Care 901-7780

INSURANCE

Equitable Advisors 338-2706

Novak Agency Inc. 388-2890

INTERNET

Bug Tussel Wireless 1-888-722-0924

Cellcom 617-7800

JEWELRY

Aude Jewelers 845-5860

LODGING

Coho Motel and Lighthouse Shop 388-3565

Harbor Lights Lodge 388-3700

Harrison Harbour House 388-0606

MANUFACTURING

Kewaunee Fabrications 388-2000

MARINAS/SALES AND SERVICES

Kewaunee Marina 388-3300

Yacht Works 388-2120

Jay's Legacy Home Care

LET US BE YOUR
 Help To Stay At Home



WHO WE ARE?

We're a small business, dedicated to providing quality care to you and your loved one. Located right here in Northeastern Wisconsin, we can provide the personal touches that larger companies cannot. Sometimes families just need a little respite care, family support for Alzheimer's, transitional help after surgeries and a little help with every day needs.



CALL US FOR MORE INFO

920-901-7780

reneedjayslegacy@gmail.com

www.jays-legacy.com

WHAT WE DO?

We provide non-medical help and companionship based on your individual needs.

Examples of services provided include:
 Housekeeping, cooking, meal prep, medication reminders, laundry, grocery shopping, appointments and help with bathing and dressing. We're here to promote independence and help you stay at home.

CALL US FOR EMPLOYMENT POSITIONS

920-901-7779



BBB Rating: A+
 As of 9/26/2022
[Click for Profile](#)

bugtussel



AT&T
Authorized Retailer

Proudly Serving Kewaunee County!

- Wireless & Fiber Internet
 - Cellular
 - Entertainment
 - FirstNet
 - Free Tech Lessons
-

Scott Nasgovitz: (920) 530-1311
BTussel.com/county/kewaunee-county/

CHAMBER MEMBER BUSINESS DIRECTORY

920 area code unless specified elsewhere

MEAT MARKETS

AlVi Lane Farm	973-1295
Glenn Innish Farm	251-7450
Konop Meats, Inc	388-3892

NON-PROFIT ORGANIZATIONS

American Legion - Post 29	Kewaunee
Don & Jean Smith Memorial Fund	Kewaunee
Kewaunee Area Chamber of Commerce	388-4822
Kewaunee Art Beat	487-3840
Kewaunee Artisan Center	304-8018
Kewaunee County Association for Home and Community Education	255-2546
Kewaunee County Economic Development Corp	255-1661
Kewaunee County Food Pantry	487-3663
Kewaunee County Historical Society	388-0369
Kewaunee Lions Club	388-4717
Kewaunee Rotary Club	388-3430
KHS Alumni Fest	388-0230
Lakeshore Community Food Pantry & Thrift Shop	388-9050
Mishicot Area Growth & Improvement	755-3411
NWTC	845-5945
Shrine of Our Lady of Good Help	866-2571
Veterans of Foreign Wars, Ralph Perry Post 3392	304-6016
Violence Intervention Project	487-2111
Help Line	837-2424
Zoological Society	388-0444

POINTS OF INTEREST

Ahnapee Trail	388-0444
Besadny Fisheries Facility	388-1025
Kewaunee County Historical Society Center	388-0369
Kewaunee Historical Jail Museum	388-7176
Marquette Historical District	388-0618
Shrine of Our Lady of Good Help	866-2571
Times Future Past	819-2640
The Tug Ludington, Harbor Park	388-5000

PRINTING

Heyrman & Green Bay Blue	499-4815
------------------------------------	----------

TITLE SERVICES

Light House Title	388-2226
-----------------------------	----------

REALTORS

Door County Board of Realtors	743-9651
The Woods, Shorewest Realtors	883-9590 & 883-6338

KONOP MEATS, INC.
STANGELVILLE
Quality Meat and Sausage - Since 1910



Monday-Friday 8-5
Saturday 8-Noon

www.konopmeats.com



When it comes to real estate in Door and Kewaunee Counties, it pays to work with a member of the Door County Board of REALTORS®

For a list of DCBR members visit dcbbr.org

CHAMBER MEMBER BUSINESS DIRECTORY

920 area code unless specified elsewhere

RESTAURANTS/PUBS

Alaskan Golf Club	388-3940
The Ballering	388-6011
Harbor Express	388-2254
Homestead	487-0105
Kewaunee Custard	388-0720
Northbrook Country Club	845-2306
Port O' Call	388-4883
Red's Pub and Grill	487-5431
Roosters	388-2162
Subway	388-3782
Waterfront Bar and Grill	388-0505
The Wildflower Supper Club	388-6076

SPECIALTY STORES/SHOPS

Aissen Tree Farm	845-5554
Alpaca to Apparel	536-1394
Dalli Moo	680-3344

Flowers & Gifts by Judy	845-2000
Glenn Innish Farms	251-7450
Katie Rabbit's	660-4692
Lighthouse Gift Shop	388-3565
Lilac Shanty	819-1426
Norman General Stores	301-0617

UTILITIES

Wisconsin Public Service Corp	800-450-7260
-------------------------------	--------------

WEDDING SITES & SERVICES

Agricultural Heritage & Resource Inc	388-0604
Lakehaven Hall	255-3328
Northbrook Golf & Grill	845-2383

WINERIES/VINEYARDS

Cold Country Vines & Wines	776-1328
Parallel 44 Winery & Vineyard	388-4400
von Stiehl Winery	487-5208



Experience

Wisconsin's Oldest Licensed Winery on the Lakeshore...

Enjoy tastings, tours and award-winning wines in our historic winery. Visit our new cider bar just two doors down from the winery. Find us in downtown Algoma on your way to Door County.

115 NAVARINO STREET • ALGOMA, WI 54201 • (920) 487-5208 • VONSTIEHL.COM



Caring for you *by the Lakeshore*

Prevea Kewaunee Health Center

1020 Marquette Dr., Kewaunee
(920) 388-0144

- Family Medicine
- Urgent Care
- Physical Therapy
- Lab
- X-ray



Walk-ins welcome Monday through Friday
8 a.m.-5 p.m. for family medicine and urgent care.

Save My Spot allows you to make an urgent care reservation
online ahead of time. Visit prevea.com/urgentcare



prevea.com



Kewaunee
Area Chamber of Commerce

SPiRiT of the LAKESHORE

308 North Main Street
Kewaunee, WI 54216

JORNS

**Chevrolet of Kewaunee
Hwy 29 West
Kewaunee**



Stop by to see our 10,000 sq. ft.
Specialty Car Showroom
920-388-0520

JORNS

Chevrolet of Kewaunee Inc
1613 Center Street
Kewaunee, WI 54216
920-388-0520 1-800-236-0010