

Kewaunee

Wisconsin's Best Kept Secret

**SPIRIT OF THE LAKESHORE 2024
VISITOR & BUSINESS GUIDE**



www.kewaunee.org



410 Milwaukee St, Kewaunee, WI
920-388-2890

mail@novakagency.com
www.novakagency.com



*Novak Agency is a family-owned business
selling insurance since 1946.*

Give us a call today!

INSURANCE SERVICES

AUTO • HOME • BUSINESS
FARM • LIFE • HEALTH
MOTORCYCLE • BOAT





Don & Jean Smith

Don and Jean believed in working together to improve their community. Today their charitable fund continues to support the Kewaunee community.

Some organizations aided by the Donald & Jean Smith Fund

Kewaunee Senior Center
Kewaunee Health & Fitness
Kewaunee County Historical Society
Friends of the Kewaunee Pierhead Lighthouse
Winter Park
Lakehaven Hall
Kewaunee Artisan Center
Kewaunee Chamber of Commerce
Zoological Society of Kewaunee County
City of Kewaunee



Individuals can make a difference.

215 N MAIN ST KEWAUNEE 920-388-0505

**DAILY FOOD
& DRINK
SPECIALS!**

**DINE IN
OR CARRY
OUT!**



Sun-Tues 11AM-CL
Weds Closed
Thurs 11AM-CL
Fri-Sat 11AM-CL

High School Students
ask for a free beverage
drink card when in!



MUSIC IN THE PARK

Sponsored by Area Businesses and Kewaunee Area Chamber of Commerce

Join us at the gazebo in Harbor Park downtown Kewaunee every Sunday 5:00-7:30pm. FREE to the public.

- June 16** **Jeff n Shed** A local duo performing acoustic hits.
- June 23** **Talk of the Town** An upbeat band sure to get you on your feet and dancing.
- June 30** **Spice Band** This local favorite is back and ready to perform a variety of rock n roll hits and golden oldies
- July 7** **Mocking Bird** A full, energetic and harmonious sound band; blending acoustic, bass, and electric guitars with vocals, keyboards and drums. They perform a variety of classic rock and country.
- July 14** **Out of the Blue** Playing a variety of favorites with a blues twist.
- July 21** **Sugarbush Boys** Polkas and other classic oldies.
- July 28** **Bazooka Joe** The boys are back in town playing hits from every era.
- August 4** **CRS 2 Band** "Can't Remember Stuff" is playing hits from the 50's, 60's, 70's and 80's
- August 11** **Modern Day Drifters** Some of our favorite crooners are back with 50 years of country hits and all-time favorites.
- August 18** **The Snow Birds** An all-star lineup of musicians that have been described as "highly melodic and heartfelt."
- August 25** **Copper Box** Roots and Americana quartet loaded with energy and instruments. Influenced by blues, jazz and rock.



Visit www.kewaunee.org for up to date information.

Food provided by area non-profit organizations. Carry in's allowed.

Bring a blanket, lawn chair, picnic basket, or cooler and relax on the scenic lakeshore.

*Rain Location is located at
Lakehaven Hall,
96 Ellis Street, Kewaunee, WI 54216.
Watch for sign in gazebo.*

Serving Rural Wisconsin **Since 2003**



Our goal and mission is to **raise the bar for internet to rural residents**, despite where they may live. Whether you work from home, your office is downtown or you are manning the family farm, we believe residents should be connected without having to compromise speed, price, quality, service or environment.

No Data Caps, No Contracts, Truly unlimited internet for Rural WI

Providing connections in
rural Kewaunee County
where other internet
providers can't or won't go

Interested?
Give us a call!

877.227.0924
btussel.com



AT&T
Authorized Retailer

Our connections go
beyond internet. We
connect rural Wisconsin
with cellular products
and services through
AT&T

Connecting

Kewaunee County



2024 CONCERT EVENTS

Algoma Concerts in the Park

Thursday nights 6-9pm at Heritage Park (off the City Marina).

June 27	Copper Box The Cougars
July 4	Time Machine Band
July 11	Big Mouth & The Power Tool Horns
July 18	Modern Day Drifters
July 25	The String Benders
August 1	Conscious Pilot
August 15	The Cougars

Luxemburg Music in the Park

Thursday nights 6pm at Fireman's Park. Free to attend, FUN for the whole family! www.luxemburgchamber.com

Mishicot Concerts at the School

June - August

MAGIC proudly presents Concerts at the School Music Series! Wednesday evenings in the great out of doors on the grounds of Mishicot High School, at 660 Washington Street in Mishicot! Concessions presented by our Mishicot area nonprofit groups are available beginning one hour prior to the concerts each week! Concerts are held rain or shine from 6:30-8pm. In the event of inclement weather, concerts are moved into the gymnasium at O.H. Schultz Elementary School. Bring a blanket or lawn chair and enjoy wonderful music in the good old Summer Time! See www.mishicot.org for concerts.

Cold Country Vines & Wines Summer Concert Series

May - September

Sundays 2:30-5pm summer music is inside our covered arena, rain or shine at E3207 Nuclear Road 3 ½ miles from Lake Michigan. We invite you to sip wine, relax, and enjoy the music. Visit our website ColdCountryWines.com for a listing of all music events.

Parallel 44 Vineyard & Winery Summer Music

June - August

Visit www.parallel44.com for complete list of dates and musicians.

von Stiehl Winery Concert Series

June 8 - September 7

Every Saturday. A cool Lake Michigan breeze, live music, a beautiful riverside view, a glass of your favorite wine, draft cider, spirits flight, or craft beer, and you have the recip for the perfect afternoon. Check our event calendar at www.vonstiehl.com

KONOP MEATS, INC.

STANGELVILLE

Quality Meat and Sausage - Since 1910



Monday-Friday 8-5
Saturday 8-Noon

www.konopmeats.com

2024 ONGOING EVENTS

Parallel 44 Vineyard & Winery Tours

May - October Visit parallel44.com for more information and to sign up, or call us at 920-388-4400 for more information.

Von Stiehl Winery Tours Visit vonstiehl.com/events

Cold Country Tour Information Kewaunee County's newest winery is situated on 16 rolling acres over-looking the East Twin River Valley. To schedule a tour, please call 920-776-1328. ColdCountryWines.com

Kewaunee Farmer's Market

Mid July - September Thursday evenings from 4-7 at Clock Corner, Downtown Kewaunee. Call 920-388-4822 for more information.

Mishicot Farmer's Market

May-October Wednesdays at Mishicot Village Hall parking lot on East side.

Algoma Farmer's Market

June 16 - October 27 10am-2pm at the Algoma Elementary School parking lot. A variety of vendors including vegetables, plants, crafts, baed goods, canned goods, wood crafted items, and more.

Tug Ludington Tugboat Tours

Mid May - Mid September Kewaunee Harbor, 920-388-5000



—TASTE WHERE IT'S CRAFTED—
ALGOMA, WI • [920] 487-5208 • VONSTIEHL.COM



**WINERY
CIDERY
DISTILLERY**

**OPEN 7 DAYS
A WEEK!**

Wisconsin's Oldest
Winery now offers
bourbon, brandy, and
cider. Visit our Wine
Tasting Room and
Spirits & Cider Bar!



2024 ONGOING EVENTS

Packers Game Day Bus

Are you in Kewaunee the day of a home Green Bay Packers game and wish you could be at the stadium? The Chamber is arranging transportation to the home games. The bus leaves Algoma approximately 4 hours before kickoff. Pick up sites are Algoma Youth Club, Algoma, Coho Motel and Grandfather Clock, Kewaunee. Ticket price includes coach bus transportation to and from the game. Parking is a short walk from the stadium. Bus leaves promptly one hour after the end of the game. Visit www.kewaunee.org for more information and to reserve your seat!

Agricultural Heritage & Resources

Mid-May to Mid-October - 9am-3pm. Blacksmith shop opens every Friday for visits and lessons.

Spring & Fall Fish Run

CD Besadny Fish Facility, Dana Farm, Kewaunee, 920-388-1025

Kewaunee Public Library

Visit www.kewauneepubliclibrary.org for weekly activities.

Friends of the Kewaunee Public Library Book Shoppe

513 Milwaukee Street, Kewaunee. Open every Friday and Saturday from 10am-3pm. Cash only. Books, DVD's, CD's VHS tapes, records, magazines, and coffee table books. Proceeds benefit the Kewaunee Public Library.

Home & Community Education (HCE)

Monthly events and meetings. Contact Jan Tess at 920-255-2546 for more information.

Senior Coffee Club at Kewaunee Library

3rd Thursday at 10:30am. Join us for coffee and conversation.

Veterans of Foreign War (VFW)

Meets at the American Legion building on the corner of Juneau & Lincoln Streets the first Thursday of each month at 7:30pm. Veterans and spouses are welcome to attend. Dinner is served before the meeting at 7pm.

Kewaunee Optimist Club

Meeting are held on the 1st & 3rd Tuesdays of the month at 7am at Anchors Down Family Restaurant, 301 Ellis Street. Our mission is to support local youth and their activities. Email kewoptimist@gmail.com for more information.

Kewaunee Lions Club

Meetings are held on the 3rd Monday of the month at Wildflower Supper Club. Call 920-255-0978 for more information.

Rotary Club of Kewaunee

Meetings are held every Thursday at noon at The Grove. Enjoy lunch and a guest speaker. Guests are welcome. <https://www.facebook.com/KewauneeRotary>

Kewaunee County's First Lavender Farm



GLEN INNISH FARM

Locally Raised Beef and Lamb

Local Lavender Fields

Hand Crafted Small Batch Lavender Products

E5247 2nd Rd – Kewaunee



Check out the
Cabin at the Glen
(short term rental)

Check out our
Website for current
hours, events and to
book the cabin
gleninnish.com

2024 CALENDAR OF EVENTS

Saturdays in February: Beat the Winter Blues Kewaunee County Historical Society will be hosting presentations on local history beginning at 1pm at the History Center located at 217 Ellis Street, Kewaunee. Events are free and open to the public. A light lunch will follow the presentation.
www.kewauneeountyhistory.com

February 10 - Kewaunee County Garden Club Bus trip to Madison for the Garden & Landscape Expo. www.kcgardenclub.org

February 12 - Tea Party at Kewaunee Public Library 3-4:30 pm.

February 18 - Second Annual Cabin Fever Farm Toy & Vendor Show Agricultural Heritage & Farm, N2251 State Highway 42.

February 24 - Frozen Tundra Wine Festival Parallel 44 Winery, 10am-4pm. Celebrate the beautiful Wisconsin winter! Enjoy wine, tours, discounts, bonfires, samples, and much more!

February 25 - Zoup Art A Fundraiser for Bruemmer Park Zoo held at Kewaunee County Fairgrounds in Luxemburg. 11am-2pm no matter the weather. Features artwork from Kewaunee County art students, raffles and of course soup from various local businesses and home cooks.
www.bruemmerparkzoo.com

March 16 - von Stiehl Winery Cabernet Tasting & Education Class 11am and 1pm. Come and celebrate and be educated on six of our cabernets! You will learn how to pair with various foods while enjoying small-bite pairings. \$40 per person in advance. Visit www.vonstiehl.com for more information and to sign up.

March 22 - Mishicot Area Ambulance & Fire Department Fish Boil & Pork Chop Dinner 3-9pm at Mishicot Fire Department.

March 23 - Easter Egg Hunt OH Shultz Elementary School, Mishicot.
www.mishicot.org.

March 23 - Roar Off the Shore 2-6pm Kewaunee County Fair Grounds. The Dyckesville and Kewaunee Lions are pleased to serve you during Roar off the Shore Brewfest. Enjoy dozens of beer and wine samples. Funds raised at this event are used within the communities. Tickets are on sale at www.roarofftheshore.com/ticket for \$40 in advance or \$50 at the door. Bus rides are available for only \$5. Reserve online.

April - Sexual Assault Awareness Month Join the Violence Intervention Project to take part in the movement to educate and spread awareness on sexual assault in the community. Like VIP on Facebook to stay up to date on any events during the month of April.

April 7 - MAGIC Annual Banquet at Par 5 Resort. www.mishicot.org

April 14-17 - National Library Week Join us at Kewaunee Public Library for a week filled with fun activities for all ages! Check out our Facebook page or www.kewauneepubliclibrary.org for more information

2024 CALENDAR OF EVENTS

April 18 - Brat Fry at Piggly Wiggly, Kewaunee. Sponsored by VFW Perry Post 3392.

April 26 - Kewaunee Rescue Fish Fry Enjoy a whitefish dinner with baby reds or potato salad, coleslaw, and rye bread. Drive thru service at the Ambulance garage, 401 Fifth Street from 10:30am-6pm. Proceeds benefit Kewaunee Rescue Auxiliary.

May 4 - Kewaunee County Historical Society Annual Meeting

1pm, featuring a presentation by Jerry Janiszewski on the history of craft breweries in the state. 217 Ellis Street, Kewaunee. A social and lunch will follow the presentation.

May 10-11 - Mishicot Village Rummage Sale

May 25 - Kewaunee County Garden Club Annual Plant Sale 9am-Noon at Lakehaven Hall. Featuring perennials, heirloom tomatoes, herbs, shrubs, and native plants, the "Traveling Sharpener" and garden décor. All plants are locally grown by club members. Call 920-304-0682 for more information.

May 27 - Kewaunee Memorial Day Parade and Program Parade begins at Kewaunee High School at 10am and stops at Riverview and Holy Rosary Cemeteries with the VFW and American Legion rendering honors. The program concludes with a veteran memorial service at the County Courthouse.

THE LIGHTHOUSE SHOP

www.lighthousegiftshop.com

- Fudge
- Cherry & Cranberry Prodcuts
- Apparel
- Outdoor Lawn Ornaments
- Nautical Decor

Suites
overlooking the
river valley
and Kewaunee
harbor!

COHO MOTEL

www.cohomotel.com

- Seasonal Rates
- Ample Boat Parking
- In-Room Refrigerator, Coffee Maker, and Microwave
- High-Speed Wireless Internet and Cable



Veteran Owned



705 N. Main Street, Hwy 42, Kewaunee, WI 54216 • (920) 388-3565

2024 CALENDAR OF EVENTS

June 1 - Kewaunee Annual Bike Safety Rodeo Held at Kewaunee School in the parking lot. Sponsored by the Optimist Club.

June 1 - von Stiehl Winery Paella Dinner Sign up at www.vonstiehl.com

June 4 - American Red Cross Blood Drive held at Immanuel Family Center 11am-5:30pm.

June 6 - Great Lakeshore Tractor Rally Agricultural Heritage & Resources Wisconsin has one of the largest number of farm tractor collections in the country. Join other collectors and enthusiasts to share your love of tractors. www.agriculturalheritage.org

June 7-8 - Kewaunee Citywide Rummage Sale 8am-4pm. Participate by having a rummage sale or browsing the town looking for a bargain. Listings will be available on the Chamber's website about a week before the sale. www.kewaunee.org

June 7-9 - Kewaunee Pierhead Lighthouse will be open for tours from 10am-4pm as part of the Door Peninsula Lighthouse Festival.

June 16 - Kewaunee County Breakfast on the Farm Enjoy a dairy breakfast, take a farm tour, and pet the farm animals. Take dad out for Father's Day! Church service at 7am. Breakfast served from 8am-Noon. The 2024 host farm is Heim's Hillcrest Dairy LLC, E3731 Rockledge Road, Algoma, WI. www.dairypromo.com

June 18 - The Adventures of Reading 1pm, location TBD. Presented by Kewaunee Public Library. This is the launch part for the summer reading program. Call 388-5015 for more information.

June 21 - 22nd Annual Kewaunee FFA Alumni Truck & Tractor Pull Kewaunee FFA Alumni Truck and Tractor Pull will begin at 6pm at the Ag Heritage Farm south of Kewaunee on Hwy 42... Come out to see many exciting pulling classes!

July 3 - Fireworks at the Shore 3pm-10:30pm. Old Fashioned Fireworks at the Lakehaven Hall, sponsored by Kewaunee Area Chamber of Commerce and Brown Fest. Kids activities, Food, Drinks, music, and Fireworks. Food provided by Muskrat City.



Fresh Frozen Custard
Flavor of the Day, Chocolate & Vanilla
Many other frozen delights
Daily specials, burgers, homemade chili
Indoor seating - Drive thru

Hwy 42, PO Box 181, Kewaunee, WI 54216 | (920) 388-0720

2024 CALENDAR OF EVENTS

July 6 - Vintage Snowmobile & Car/Motorcycle Show

Hosted by Lakeshore Area Vintage Snowmobile Association, Downtown Kewaunee. Registration 8am-Noon. Trophies at 4pm. Call Bob at 920-255-4272. For information on the car/motorcycle show, contact Tyler at 920-360-9156.

July 11-14 - Kewaunee County Fair 9am-10pm Kewaunee County Fair Grounds. The 107th Kewaunee County Fair is sure to be packed with fun, including live music, carnival rides and games, livestock, small animals, 4-H displays, grandstand shows, kids' entertainment, food and much more. www.kewauneeountyfair.com

July 12-21 - 42nd Annual Kewaunee/Door Salmon Tournament

The K/D Salmon Tournament is an amateur sport fishing tournament in Kewaunee and Door counties in Northeastern Wisconsin. Thousands of anglers participate annually, competing for \$50,000 in cash and prizes. The heaviest fish caught wins the lucky fisherman \$10,000 CASH. There are 45 daily port prize packages plus a payout that goes well over 100 places deep.

July 14 - Kewaunee County Fair Parade Starting at 11:30am in Luxemburg. www.luxemburgchamber.com

July 18 - Brat Fry at Piggly Wiggly, Kewaunee. Sponsored by VFW Perry Post 3392

Kewaunee County's Finest
Open Year-Round



harbor lights lodge



- 33 Deluxe Guest Rooms and Suites
- Computer with Internet in Lobby
- Handicapped Accessible Rooms Available
- Harbor View Rooms with Private Balconies
- In-Room Wireless High Speed Internet Access
- 25-Inch Cable TV
- All Rooms Feature AM/FM Clock, Hairdryer, Coffeemaker, Microwave & Refrigerator
- Ample Boat Parking & Nearby Ramp

211 Milwaukee Street (Hwy. 42), Kewaunee, WI 54216

(920) 388-3700 or 1-800-736-3700

www.harborlightlodge.com harbor@harborlightlodge.com

2024 CALENDAR OF EVENTS

July 20 - Alumni Fest Lakehaven Hall, Noon-10:30pm. Back for another year of live music, refreshments, and raffles. AlumniFest is a multi-year gathering of classmates, teammates, and life-long friends. AlumniFest, Inc. is a registered nonprofit. Monies raised support civic and educational activities in Kewaunee County. Donations fund this event. www.facebook.com/khsgrads

July 20 - Kewaunee Pierhead Lighthouse Open for tours from 10am-4pm.

August 9-11 - Shanty Days "Celebration of the Lake" in Algoma, is a three-day fun filled family festival that has become an Algoma tradition. www.visitalgomawi.com

August 17 - 10th Annual Soar on the Shore 11am-4pm. It's kites galore as Unique Flying Objects of Two Rivers, the WI Kites Club, the Algoma Area Chamber of Commerce and Friends of Crescent Beach invite you to join them for a fun-filled day on Crescent Beach & Boardwalk in Algoma! www.visitalgomawi.com

August 20 - Fall Fun Fest Potluck Hosted by Home & Community Education (HCE) at the Highway Department 4280 County Road F. Guests are welcome. Contact Jan Tess at 920-255-2546 for more information.

September 13 - Kewaunee Rescue Fish Fry Enjoy a whitefish dinner with baby reds or potato salad, coleslaw, and rye bread. Drive thru service at the Ambulance garage, 401 Fifth Street from 10:30am-6pm. Proceeds benefit Kewaunee Rescue Auxiliary.

September 19 - Brat Fry at Piggly Wiggly in Kewaunee. Sponsored by VFW Perry Post 3392.

September 20-21 - Wet Whistle Wine Fest Sponsored by von Stiehl Winery. Proceeds benefit Algoma Fire & Rescue. Wet Whistle Wine Fest offers award-winning wines, a grape stomp, hearty sandwiches, and live music!

September 21-22 - 31st Annual Heritage Days at the Kewaunee County Fairgrounds in Luxemburg. A fun family event that includes wonderful food, music, wagon rides, and much more. www.agriculturalheritage.org

September 28 - Zoobilee 10am-4pm at Bruemmer Park Zoo. Car show, face painting, food, wagon rides and more!

Al-Vi Lane Farm

Est.



1947

Farm Fresh Beef

Jerrod & Cheryl Schleis

920-973-1295 | jerrod.schleis@gmail.com

4733 Schleis Rd. Two Rivers, WI 54241

Located just West of Highway 42 between Kewaunee and Two Rivers

Offering whole, half and
quarters of beef for direct butcher
AND
individual cuts/bundles sold off
the farm.

• • • • •

Contact us through phone, email,
or Facebook to place an order or
for inquiries!

2024 CALENDAR OF EVENTS

October - Domestic Violence Awareness Month/Bullying Prevention Awareness Month

Join the Violence Intervention Project as we take part in the movement to educate and spread awareness on domestic violence/bullying prevention in the community. Like VIP on Facebook to stay up to date on events during the month of October.

October 4-6 - Lighthouse Festival Kewaunee Pierhead lighthouse will be open for tours from 10am-4pm as part of the Door Peninsula Lighthouse Festival.

October 19 - Mishicot Pumpkin Fest Visit www.mishicot.org

October 26 - Autumn Luncheon & Style Show hosted by HCE. The event will be held at the Waterfront Banquet Hall with fashions modeled by Hello Dolly, Dalli Moo, and Pretty Please Boutique. Call Debbie at 702-927-0969 for more information.

October 31 - Havoc at the Hall Lakehaven Hall, 96 Ellis Street at 4pm. Free Admission. Halloween Event for kids ages 4-12 but fun for the whole family! Games, prizes, and spooky fun. Watch the Lakehaven Hall Facebook page or their website, www.lakehavenhall.com for more information.

November 11 - Veterans Day Memorial Service 11am Downtown Kewaunee at Milwaukee and Ellis intersection. Then proceed to the memorial at Kewaunee Courthouse for a wreath presentation.

November 16-17 - Aissen Tree Farm Christmas Open House
Visit www.aissentreefarm.com for more details.



Rustic cabins, newly renovated heated pool,
full hook ups, pull through sites,
grounds are big rig friendly,
bike trail and boat launch nearby.

920-388-4851

www.kewauneerv.com

333 Terraqua Drive, Kewaunee



2024 CALENDAR OF EVENTS

November 21-23 - Kewaunee County Historical Society Bake Sale

10am-4pm. Stop in on your way to Christkindlmarkt or while on the Stroll and enjoy some traditional baked goods!

November 22-23 - Christkindlmarkt Experience a traditional, centuries old European Christmas Market. Shopping, kids' activities, music, traditional German meal, and many vendors. Friday 3-9pm. Saturday 10am-5pm. Kids can visit Santa Friday evening from 7 until 9 and again on Saturday.

November 22 - Holiday Parade of Lights Begins in the Kewaunee Grade School parking lot at 6:30pm and heads to Lakehaven. Enjoy music and floats and of course, Santa Claus!

November 22-23 & 29-30 - Kewaunee County Christmas Stroll Stroll Kewaunee County businesses from 10am-4pm and discover great art, wines, food, and special holiday treats throughout the county. Get your passport stamped for a chance to win cash prizes! www.kewaunee.org

December 7 - Mishicot Christmas in the Village Visit www.mishicot.org

December - Winter in the Village Lakehaven Hall, 96 Ellis St. Step back in time and experience old time Christmas villages, stroll through a winter wonderland, and enjoy the entertainment with a hot beverage and a little snack. Watch the Lakehaven Hall Facebook page or www.lakehavenhall.com for more information and dates for this wonderful event.



KEWAUNEE'S PREMIER FULL SERVICE SALMON AND TROUT FISHING CHARTER

ENJOY A FUN AND EXCITING
FISHING TRIP ON OUR
WELLCRAFT COASTAL.

TRIPS FOR ALL AGES
TO EXPERIENCE THE FUN
OF REELING IN SOME
LAKE MICHIGAN SALMON

BOOK YOUR TRIP TODAY AT HARBORVIEWCHARTERS.NET

DANA FARM ICE SKATING RINK

The Dana Farm Ice Skating Rink, a project primarily funded with a generous donation from Kewaunee County Farm Technology Days 2017, is an outdoor ice rink that is FREE to use during the months of January and February or as long as the ice is in good condition.

The ice rink, which is located at N3787 Ransom Moore Lane, Kewaunee and adjacent to Winter Park, is typically open to the public seven days a week from the hours of 9am - 8pm and it is lighted for night skating.

Visitors must bring their own skates, rentals are not available. The ice rink is unsupervised, so it is use at your own risk, and the Kewaunee County Promotions & Recreation Department asks that visitors be patient if staff needs to clear snow from the ice.

There is a park shelter with public restrooms that can be used year round, which includes those taking advantage of the 27-hole disc golf course that winds around Winter Park during the warmer months.

To check on current ice conditions at the Dana Farm Ice Skating Rink, call 920-388-7199, and for more information visit www.kewauneeco.org look under the Promotions & Recreation Department as well as www.VisitKewauneeCounty.com.



"WHERE QUALITY IS NO ACCIDENT"

AUTO BODY / COLLISION REPAIR

ALL MAKES AND MODELS, ALL INSURANCE WELCOME

CHRIS & ERIN CARTER, OWNERS

CARTERSCOLLISION306@GMAIL.COM

N3050 COUNTY ROAD B, KEWAUNEE, WI 54216

WINTER PARK

Winter Park is best known for snow tubing, skiing, snowboarding, and snowshoeing. The park is typically open to the public on the weekends during the months of January and February.

The snow tubing hill features five lanes approximately 450 feet long with a vertical drop of 70 feet. Getting to the top of the hill is easy as riders can hop on a "Magic Carpet", a standing conveyor belt system that transports visitors up with their tubes in approximately two minutes. Snow tube riders are required to be at least 42" tall for safety reasons.



The skiing/snowboarding area has five runs some over a quarter mile in length with a 160 foot vertical drop with a T-bar lift that brings skiers and snowboarders to the top. There is also a beginner's hill for those just learning the sport that is equipped with a tow rope lift system.

Visitors are also invited to snowshoe around the park's trail system for FREE.

Winter Park offers ski, snowboard and snowshoe equipment rentals and has a warming chalet with concessions, public restrooms, tables, chairs and storage cubbies.

Winter Park also doubles as a 27-hole disc golf course during spring, summer and fall. It's rated eighth in the state by Disc Golf Course Reviews. The scenic course covers the entire park. You'll find a donation tube located at the park for upkeep.



**The park is located at
N3787 Ransom Moore Lane, Kewaunee**

**To check on current conditions, call 920-388-7199
and like Winter Park - Kewaunee County on Facebook.**

Visitors can find park hours and rates for activities online at
www.kewauneeeco.org under the Promotions & Recreation Department
as well as **www.VisitKewauneeCounty.com**.

HISTORIC DOWNTOWN WALKING TOUR

Take a tour of Kewaunee's historic downtown area and experience a city vital to Wisconsin's past, present, and future!

Please visit the Kewaunee Historical Society for more information about these landmarks



Grandfather Clock Kewaunee boasts the world's largest grandfather clock at 35' 10", originally built by Svoboda Industries in 1976 for the U.S. Bicentennial Celebration.

Tug Ludington The Ludington, christened the Major Wilbur F. Browder, participated in the D-Day invasion and continued to assist in harbor operations. In 1947, the tug was stationed in Kewaunee by the Army Corps of Engineers.

Railroad Depot Built in the 1890s, the Depot accommodated passenger service from the Green Bay and Western Railroad between Kewaunee and Green Bay; a spur from Kewaunee led to Door County.

Life Saving Station Originally built in 1893, the Life Saving Station was one of many that served as the precursor to U.S. Coast Guard working tirelessly to save lives in a growing shipping industry. The station continued under the Coast Guard until its closure in 1947.

HISTORIC DOWNTOWN WALKING TOUR

Kewaunee Lighthouse As Kewaunee became an increasingly vital port connecting Wisconsin and the Midwest to the Eastern U.S., the Lighthouse served as the centerpiece to assist incoming and outgoing ships.

Priebe Cold Storage (Port O' Call Restaurant) The Priebe Cheese Cold Storage building, built in 1935 replacing the old Crosby and Meyers Cheese House that formerly occupied this site.

Emerald and Dickinson The coal barges, Emerald and Dickinson, sank off the coast of Lake Michigan near Kewaunee on November 17, 1885 leading to the construction of the Life Saving Station.

Light Plant In 1892, a group of citizens requested streetlights from the city council. In 1895, an ordinance was passed to construct an electric light plant. The light plant was finally built in 1908, and Kewaunee got electric lights.

Lakehaven Hall Part of the Hamachek Machine Company established in 1898, included a foundry, planing mill, machine shop and lumber warehouse.

Karsten Hotel In 1858, the Steamboat House was built on the current Karsten Hotel site, serving as a major hub for social activities. On February 14th, 1912, a fire destroyed the building. The hotel is claimed to be home to three spirits: William Karsten, the former owner; Billy Karsten III, his grandson; and Agatha, a maid who had worked and lived at the hotel.

Doctor's Office Considered the oldest doctor's office in Wisconsin, it was built in 1873. Dr. Oliver Martin began practice in Kewaunee on March 2, 1874. It was also the site of the first volunteer-type lending library

Kewaunee Bottling Company (Kewaunee Artisans Center) The Kewaunee Bottling Company aka Pop Shop began in 1919 with one truck and a horse-drawn sled. The company distributed a variety of beers and manufactured Double Cola, Bubble Up, Squirt, Baumeister Root Beer, Orange, Cherry and Cream sodas.

Parkos Mobil This Tudor revival-style Walden Service Station opened in 1931. In 1976, it was sold to Parkos Oil and remains a service station today.



Goodrich Dock The Goodrich boats traveled the Lake Michigan waters in the late 1800s carrying cargo and passengers. Docking in this area, they were near Wanninger's Pea Factory and Seyk's Grain Elevator.



USS Pueblo Between 1941 and 1946, Kewaunee Shipbuilding and Engineering delivered 80 vessels to the U.S. Government. Its most newsworthy ship was the USS Pueblo when, on January 23, 1968, she was captured by the North Koreans; the crew and her captain were accused of espionage.

Shop ✿ Learn ✿ Create



Craft Boutique & Retreat



Lilacshanty.com
N9003 County Rd. DK Luxemburg

PLANNERS | ARCHITECTS | BUILDERS



Keller™

Planners | Architects | Builders

Building Trust since 1960

100% EMPLOYEE OWNED

KELLERBUILDS.COM

1.800.236.2534



MARQUETTE HISTORICAL DISTRICT

The Marquette Historic District is a distinctive residential neighborhood of fine homes located within the heart of Kewaunee. The Marquette Historic District, which is listed in the National Register of Historic Places, consists of forty-three homes. Take a self-guided walking tour on the city streets to experience these showcased homes built in the late 1880's through the early 1900's by some of Kewaunee's most prominent businessmen. Expect to find a variety of Italianate, Second Empire, Queen Anne, Craftsman, Prairie, American Foursquare, and various Period Revival styles of architecture.



Guidebooks are available for purchase at the Chamber Tourist Information Center. This tour is well worth your time!

Kewaunee County Historical Society & Jail Museum

100th Anniversary 1921-2021

50th Anniversary 1970-2020



History Center
217 Ellis Street, Downtown Kewaunee
Open Thurs. and Fri. 10:00am - 4:00pm
(920) 388-0369



Jail Museum
613 Dodge Street, Kewaunee
Open Memorial Day - Labor Day
Thurs - Sun, Noon - 4:00pm



HARV'S
ELECTRIC

Remodels & Additions
Residential & Commercial

WE SELL SERVICE, AND INSTALL
MAJOR APPLIANCES, FURNACES & GENERATORS

401 Milwaukee Street, Kewaunee | wiredharvs@gmail.com | (920) 388-3699

MARQUETTE HISTORICAL DISTRICT

- 1) 805 Dodge St
- 2) 324 Center St
- 3) 816 Dodge St
- 4) 822 Dodge St
- 5) 821 Dodge St
- 6) 416 Rose St
- 7) 900 Dodge St
- 8) 903 Dodge St
- 9) 909 Dodge St
- 10) 915 Dodge St
- 11) 921 Dodge St
- 12) 314 Dorelle St
- 13) 1004 Dodge St
- 14) 1003 Dodge St
- 15) 1018 Dodge St
- 16) 1021 Dodge St
- 17) 1102 Dodge St
- 18) 1103 Dodge St
- 19) 1109 Dodge St
- 20) 1112 Dodge St
- 21) 1118 Dodge St
- 22) 1119 Dodge St
- 23) 1203 Dodge St
- 24) 1213 Dodge St
- 25) 1122 Milwaukee St
- 26) 1104 Milwaukee St
- 27) 1026 Milwaukee St
- 28) 1020 Milwaukee St
- 29) 1017 Milwaukee St
- 30) 1012 Milwaukee St
- 31) 1009 Milwaukee St
- 32) 1003 Milwaukee St
- 33) 222 Dorelle St
- 34) 205 Dorelle St
- 35) 922 Milwaukee St
- 36) 916 Milwaukee St
- 37) 908 Milwaukee St
- 38) 210 Rose St
- 39) 204 Rose St
- 40) 205 Rose St
- 41) 820 Milwaukee St
- 42) 815 Milwaukee St
- 43) 804 Milwaukee St
- 44) 803 Milwaukee St

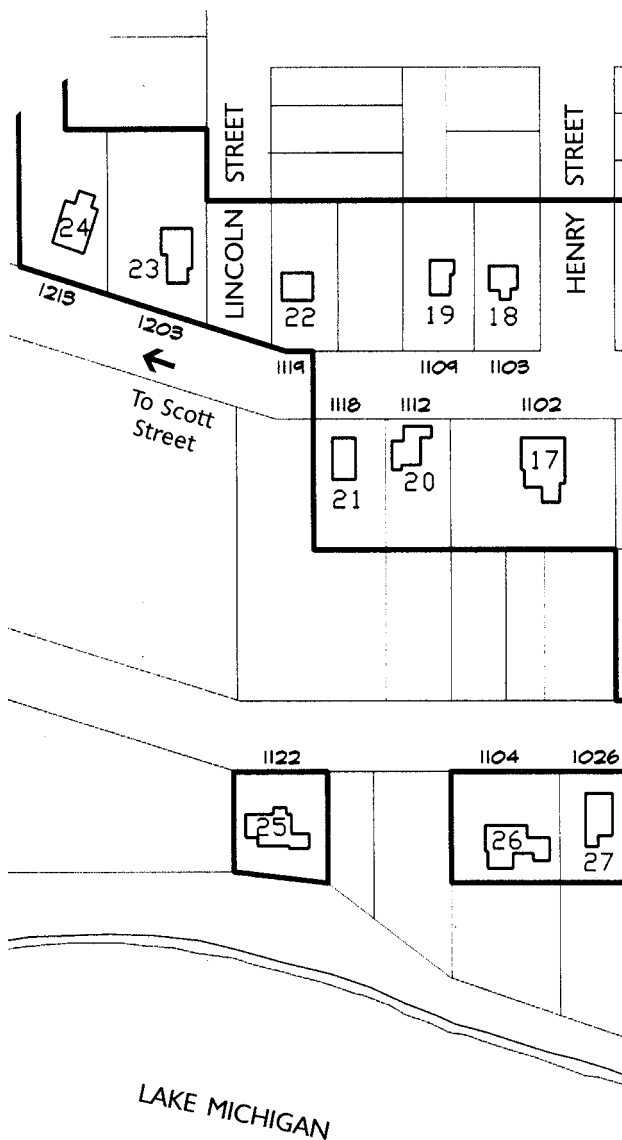

MARQUETTE HISTORICAL DISTRICT

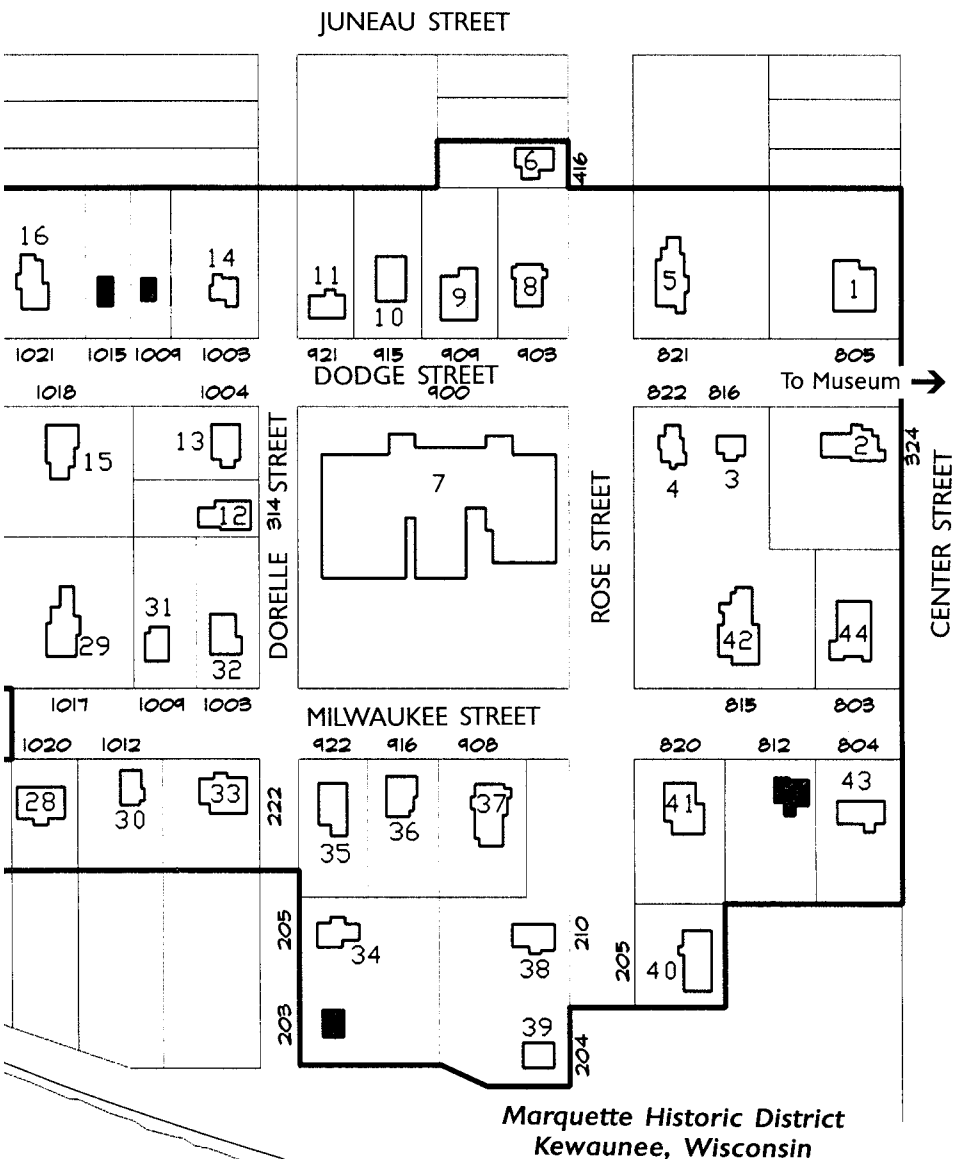

Marquette Historic District
Kewaunee, Wisconsin

KEWAUNEE PARKS



- A - AHNAPEE TRAIL, GRANFATHER CLOCK, FIRE MUSEUM**
- B - MARSH WALK PARKS**
- C - FATHER MARQUETTE**
- D - HARBOR POINT**
- E - HARBOR**
- F - PIONEER**
- G - SELNER**
- H - HANEY**
- I - LIGHTHOUSE / DON & JEAN SMITH MEMORIAL PARK**
- J - KEWAUNEE MEMORIAL & KIEWIG**
- K - BREUMMER (CTY C AND CTY F)**
- L - WINTER (CTY C WEST, LEFT ON CTY F)**

**Contact City Hall
for Pavilions available
for rent:
920-388-5000**

CHAMBER BUSINESSES

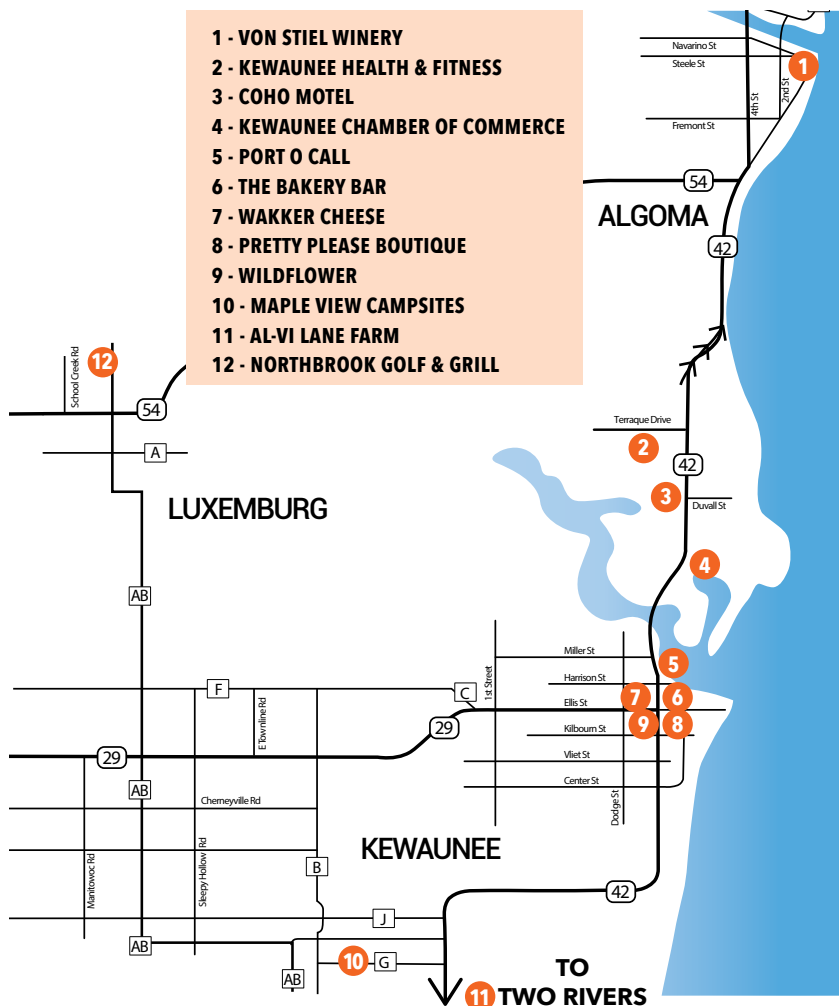

NORMAN GENERAL STORE

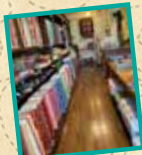

Quilt Fabric, Vintage Wares,
Made in Wisconsin Gifts & More.

Hours vary by season. Visit our Facebook page or
normangeneralstore.com for current schedule.

E3296 COUNTY ROAD G
KEWAUNEE, WI 54216
920-301-0617 CALL / TEXT

FESTIVALS

Sponsored by Kewaunee Area Chamber of Commerce

July 3

Old Fashioned **FIREWORKS** at the Lakeshore

Sponsored by your Kewaunee Area Chamber and Brown Fest

Wednesday, July 3, 2024

FOOD • DRINKS

Lakehaven Hall, Kewaunee

Brats, Burgers, Hot Dogs & more starting at 4:00 pm

by Muskrat City Sportsman's Club

Kids Activities and Games: 3:00 pm-Dusk

Music by The Cougars: 4:00 pm-Dusk

Fireworks begin at dusk



Kewaunee Art Walk

*Local artists have painted banner art that will be displayed
in downtown Kewaunee from July 3rd through early fall.*



Call 920-388-4822 or visit www.Kewaunee.org for more information

No food or beverage carry-ins

FESTIVALS

Sponsored by Kewaunee Area Chamber of Commerce

GREEN BAY PACKERS GAME DAY BUS

The Kewaunee Area Chamber of Commerce is arranging transportation via motorcoach bus to home Packers games for visitors and local residents.

Pick-up Locations:

Coho Motel, Kewaunee

Grandfather Clock

Algoma Youth Club, Algoma

Bus picks up 4 ¼ hours before game time from Algoma, 4 hours from Kewaunee. Return bus picks up one hour after the game (a few blocks south of Lambeau Field)

For more information, contact 920-388-4822 or 920-388-3565

Reservations can be made at www.kewaunee.org

SPONSORED BY KEWAUNEE AREA CHAMBER OF COMMERCE & A&W

KEWAUNEE AREA CHAMBER OF COMMERCE ANNUAL

Christkindlmarkt

LAKEHAVEN HALL



HOLIDAY MARKET

German Food & Visit with Santa

Friday, November 22, 3–9pm

Holiday Lights Parade 6:30pm

Saturday, November 23, 9am–4pm

KEWAUNEE COUNTY CHRISTMAS STROLL

Visit area shops to win prizes

Friday-Saturday, November 22-23 & 29-30
10am–4pm

BESADNY ANADROMOUS FISHERY

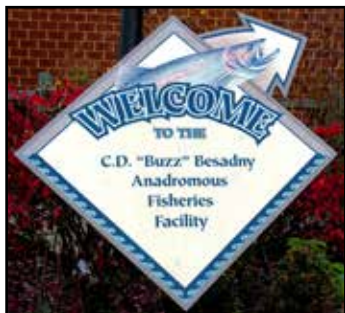

Where Salmon Eggs are Turned Into Salmon

The Wisconsin Department of Natural Resources (WDNR) operates a fish egg collection station near the City of Kewaunee. The WDNR's Besadny Anadromous Fisheries Facility (BAFF) is nestled in a secluded area along a quiet, scenic stretch of the Kewaunee River. Trout and salmon migrating from Lake Michigan are led by flowing water past two underwater viewing windows to a fish ladder -

a series of waterfall-like steps - that leads to six collection ponds. Fish are moved from the ponds through the spawning process in the building and back to the river - upstream of the barrier dam - to continue their upstream migration.

History in the Making

Trout and salmon have been stocked into Lake Michigan since the early 1960's. Prior to the construction of BAFF, WDNR has relied, at least in part, on other agencies for eggs and/or fish of several species or strains to maintain the trout and salmon sport fishery in Wisconsin waters of Lake Michigan. BAFF is designed to serve as a collection station for trout and salmon eggs but the staff there also hatch and raise both lake sturgeon and spotted musky for stocking into Lake Michigan and Green Bay respectively. Additionally, BAFF provides a scenic place for the general public to observe migrating fish and to learn about fisheries and other WDNR programs through tours and educational programs offered by the facility.



Why We Do the Things We Do

The primary objective of the WDNR trout and salmon stocking program for Lake Michigan is to provide a diverse sport fishery for anglers. Each year WDNR stocks millions of trout and salmon into Lake Michigan tributary streams to provide a put-grow-and-take in the lake and sport fishery in the tributary streams. Since most Wisconsin tributary streams lack the potential to support adequate natural reproduction, adult trout and salmon must be collected each year and spawned. Their progeny are raised in hatcheries and stocked back into the tributaries to complete the cycle.



BESADNY ANADROMOUS FISHERY

When Can We See the Fish Jumping?

BAFF operates from March through December with exact dates dependent upon spawning migrations of the various fish species. For specific days either see our electronic display sign in the building lobby or call the number listed below. Migration times for the spring steelhead occur from early March through early May. The chinook salmon run begins in mid-September and continues through mid-November. The fall coho salmon run occurs from mid-September through late October. Seeforellen brown trout begin to enter the stream by mid-October and continue to run until the river ices up in late December.

Hours of Operation

The Besadny Fisheries Facility is open to the public for viewing every day of the year during daylight hours. Fish are not always present. However, general spawning migration periods are listed above. Please call the number listed below if you need more information. Special group tours are available and can be arranged by calling the Besadny Facility manager at 920-388-1025. Information and educational displays also lead visitors on a self guided tour and provide basic information on trout and salmon life history, facility operation, and other related subjects. *We look forward to seeing you in the future!!*



In-house-made Cheeses • Imported Cheeses
Artisan Bread • Traditional Dutch Treats
Warm & Friendly Atmosphere

*Fresh brewed coffee and teas
are also available
for takeout and inside consumption*

409 Milwaukee Street, Kewaunee, WI • 920-388-6500



A Friendly Place For You and Your Family

**Hope for the Future
Peace with Jesus
Purpose for Life**

Join Us For Worship
Sunday 9:00 am
Monday 6:30 pm

1012 Wisconsin Ave. Kewaunee, WI 54216

920-388-2592

www.immanuelutherankewaunee.org

Kewaunee Marina

Located at the Highway 42 Bridge & the Kewaunee Harbor



Photo courtesy of Brian Huben Photography

100-Slip Full-Service Marina

Daily, Weekly & Seasonal Dockage Available

Clean, Private Showers & Restrooms

Fish Cleaning Station

Fuel Dock • Marina Sanitation Pump

Gas Grills • TV, Weather Channel & Internet Access

Campground Sites (Full hookup & primitives)

Boat Trailer Storage Area

Public Boat Launch Facility

123 N.Main Street, P.O.Box 256, Kewaunee, WI 54216

(920) 388-3300

marina@cityofkewaunee.org | www.cityofkewaunee.org

CHARTER FISHING

Kewaunee, WI is home to some of the best King Salmon and Trout fishing in the Midwest. Kewaunee is located on the Northwestern shore of Lake Michigan. Here you will find some of the most knowledgeable charter captains with up-to-date vessels with many amenities. Booking a charter out of Kewaunee will offer you many opportunities to potentially target various species of fish. Examples of fish you may be able to catch are King Salmon, Coho Salmon, Steelhead/Rainbow Trout, Brown Trout and Lake Trout.

Kewaunee is known for producing large numbers of big fish. Charter fishing season generally runs from May to the beginning of October. The boat landing and fish cleaning facilities allow you to bring your own boat to enjoy the fishing experience.

When booking a charter fishing trip, Kewaunee also offers you an opportunity to enjoy many other sites and accommodations. From beautiful campgrounds, concerts in the park, farmers markets and winery tours. Visitors also love seeing the WWII Tug Ludington, taking a lighthouse tour, and viewing the world's largest grandfather clock.

If you are looking to enjoy a great fishing experience, consider booking a charter fishing trip in Kewaunee with a Captain today!

Home Wrecker Sport Fishing Charter



**Fish aboard the HOMEWRECKER,
a 40ft Egg Harbor yacht out of the port of Kewaunee, WI
Call Captain Roy at 920-536-0080**

AREA ATTRACTIONS

The Anadromous Fish Facility In Fall and Spring, make sure you stop by to watch trout and salmon struggle up the fish ladders into special holding tanks for spawning. This facility is run by the Department of Natural Resources. If you stop by on the right day, you will see DNR personnel stripping eggs for the hatchery in the facility. Take a look at the underwater process from a window installed by the Algoma-Kewaunee Great Lakes Sports Fishermen. You also might want to adventure on one of the trails along the river. To get to the facility take Hwy. 29 west, turn right on County C to County F, turn left past Bruemmer Park then turn right on Ransom Moore Lane.

Ahnapee State Trail A "rails to trails" conversion has removed the tracks on this 30-mile trail that connects Kewaunee, Luxemburg, Casco, Algoma and Sturgeon Bay. During spring, summer, and fall; hikers, bikers, horseback riders, and horse-drawn carts and wagons share the trail. In winter, cross country skiers and snowmobilers whisk across its frosty surface. For trail condition reports and further information about county events call 920-388-7199, or for general information visit: www.ahnapeestatetrail.com or call 920-388-0444.

Golfing Experience golfing at its best. Kewaunee area offers 3 different beautifully landscaped golf courses. Located on Hwy 42 between Kewaunee and Algoma is Alaskan Golf Course. This golf course offers 9 holes of golf. Call 920-388-3940 for reservations. Nestled in the heart of Luxemburg, is Northbrook Golf & Grill. Northbrook Golf & Grill is a 4.5 Star course offering 18 holes of golf. Call 920-845-2383. Par 5 Resort located in Mishicot offers 45 holes of challenging golf (featuring the 18 hole links course of The National and the skillfully landscaped parkland-style of Fox Creek 27 hole course). Call 920-755-4000 for reservations.



PORT O' CALL HARBOR CENTER

*Opening
Summer
2024!*

**Bar & Food with Outdoor Beer Garden,
Pet-Friendly Patio, Live Music, and Lawn Games**

Recreational Equipment Rentals

Pontoon Boats • Kayaks • Stand-up Paddle Boards
E-Bikes • EV Chargers



facebook.com/PortOCallKewaunee

310 Milwaukee Street, Kewaunee • 920-388-4883

AREA ATTRACTIONS

Harbor Park Stop for a quiet afternoon, pack a picnic lunch, pull up a table, and enjoy the Kewaunee ambiance. Watch the harbor for jet skiers, fishermen, and sailboats ready to enjoy the beautiful Lake Michigan water. On Sundays in summer, Harbor Park is the site of Music in the Park. Pull up a lawn chair and experience some of the best music on the lakeshore.

Heritage Farm Located just south of Kewaunee at N2251 State Highway 42, is the home of Agricultural Heritage and Resources; a not-for-profit association committed to preserving agriculture's diverse heritage and promoting its future.

Kewaunee County Bruemmer Park Located about 2 miles west of Kewaunee where Cty C intersects with Cty F. Visitors can enjoy a relaxing day with family and friends. The park features a small zoo with animals that include Nigerian dwarf goats, arctic foxes, bobcats, Barbados blackbelly sheep, peacocks and deer. The park also features a large playground and several shelters for family picnics and parties. Call the Promotion & Recreation Office at 920-388-0444 to reserve a shelter for special events.

Kewaunee County Historical Society Center "If you can't find grandma, you can find her here." Extensive Kewaunee county business and family history, including newspaper clippings, scrapbooks, audio interviews; also 32,000 photos on file. Museum type displays. Children's area. Located at 217 Ellis St., Kewaunee. Open Thursday and Friday 10am-4pm. For more information call 920-388-0369.

Kewaunee Historic Jail Museum Built in 1876 as the sheriff's residence and county jail. Three floors of local history includes a life size basswood statuary of Father Marquette's 1674 landing in Kewaunee, a 5'x6' hand carved diorama of Custer's last stand, and a model of the U.S.S. Pueblo, an electronic ship built and launched in Kewaunee in 1944 and captured in 1968 by the North Koreans. Located at 613 Dodge St., Kewaunee. Open Noon-4pm Thursday - Sunday. For more information call 920-388-7176.

Kewaunee Fire Department "May we display commitment through courage, compassion and camaraderie." The KFDAL is honoring the current and past members of the Kewaunee Fire Department with the Fire Museum. The museum houses 4 of the first 5 pieces of equipment that the Kewaunee Fire Department started with in 1900. The museum is possible through the many donations that community members have donated towards this project.

Kewaunee Tourist Information Center & Chamber of Commerce Located over the bridge on the north side of Kewaunee. Stop in to gather information on more than 100 local businesses in the Kewaunee area. During the summer the Chamber is open daily from 9am-4pm. Ask our knowledgeable volunteers any questions you have about the area. You will also find Wisconsin road maps and information about Wisconsin. We can't wait to assist you.

Kewaunee's Victorian Pierhead Lighthouse Fully operational year-round, with both a main light and a fog signal. Visitors may walk out to the end of the pier and view the exterior of the lighthouse. See page 36-37 for details.

Kewaunee Winter Park See page 15 for more details.

AREA ATTRACTIONS

Pioneer and Selner Park Just one block from Kewaunee's downtown area, the parks feature public beaches and swimming areas. Pioneer Park is located at the east end of Kilbourn Street, across from the Vollrath Company. It includes a shaded grassy area for picnics, swings and teeter-totters for children, and a sandy beach. Selner Park is just a block south. Swimming is at one's own risk with no lifeguard available. Two other parks are on the water, north of the bridge. Father Marquette Memorial Park sits at the foot of the hill on Lakeshore Drive, with a kitchen and restroom facility. Harbor Point Park has grills and a picnic area with a great view of the harbor.

Riverview ATV Park 20 miles of trails designed for those who love an adventure on their ATV, UTV or dirt bike. The park is open early May through mid-November. Helmets and a valid WI registration are required. You'll find a donation tube located at the park for upkeep. The park also has 3-miles of mountain bike trails. More information on park rules and regulations can be found on VisitKewauneeCounty.com or by calling the Promotion & Recreation Office at 920-388-0444.

The Shrine of Our Lady of Champion Known as "The Chapel" by the local inhabitants, the Shrine of Our Lady of Champion is built directly over the site where Mary "The Queen of Heaven" appeared to Adele Brise, a young Belgian immigrant woman, in October of 1859, one year after the Marian apparitions occurred at Lourdes. The Shrine of Our Lady of Good Help is located on 6 acres of peaceful farmland just 15 miles Northwest of Kewaunee in Champion, WI.



You are invited to come to the Shrine of Our Lady of Champion. For over 150 years the faithful have come to this hallowed site seeking the intercession of the Blessed Virgin Mary.

Our Lady of Good Help at Champion, WI is the only site in the United States of an approved apparition of the Blessed Virgin Mary.

920-866-2571
4047 Chapel Drive, New Franken, WI 54229

www.championshrine.org



TUG LUDINGTON



Made for WWII, the Tug Ludington was built at Jacobson Shipyard in Oyster Bay, New York. In February of 1943 the Keel was laid and the tug was finally finished in October of that same year.

The U.S. Army accepted and christened the tug "Major Wilbur F. Browder" and designated the tug LT-4. The tug's armament consisted of two 50 caliber machine guns mounted above the chartroom and pilothouse.

The tug participated in the D-Day invasion of Normandy, towing ammunition barges across the English Channel. After Normandy it traveled to Cherbourg, France to assist in harbor operations until being sent to Plymouth, England until the end of the war. After the war, it joined the U.S. Army Transportation Corps and returned to Norfolk, Virginia where it continued service along the eastern seaboard.

In 1947, the Corps Of Engineers transferred the tug to Kewaunee, WI and then renamed it the "Tug Ludington". While in Kewaunee it was used in the construction and maintenance of many harbors on the Great Lakes. The Tug has towed a wide variety of floating equipment. It is estimated that the Tug has hauled over 1 million tons of cargo.

The Tug now rests in Harbor Park in downtown Kewaunee and is open to visitors from June until Labor Day. The Tug is registered in the National and State Register of Historic Places.

For tour information and questions, call Kewaunee City Hall at 920-388-5000.



*Rooster's is a favorite
among locals and visitors alike,
stop in for good times with great people!*

**LIVESTREAMING KEWAUNEE STORM
ATHLETIC EVENTS**

**207 ELLIS STREET, DOWNTOWN KEWAUNEE
ROOSTERSBARKEWAUNEE.COM**



KEWAUNEE FIRE DEPARTMENT

Earliest records reveal that Kewaunee's first Fire Department was organized on March 20, 1870. The department consisted of two groups called Fire Company No. 1 and Hook and Ladder Company No. 1. Equipment used by the firemen at the time were buckets, axes, shovels and ladders. That same



year, the City of Kewaunee purchased a used "Hand Tub" pumping engine from the City of Milwaukee. The "Hand-Tub" was built as the #266 in 1845 by W.C. Hunneman & Co. of Boston. In 1884 a new hand fire engine arrived from New York. In 1898 both volunteer organizations, the Fire Company and the Hook and Ladder Company of Kewaunee, sent notice to the common council of being dissolved, leaving the city without any organization to man the fire apparatus in the event of fire. The mayor appointed thirty able bodied men to act as a temporary fire department. The city quickly authorized the purchase of a new American Steam Fire Engine from New York, followed by an ordinance establishing and regulating the Kewaunee Fire Department.

Today, the fire department has grown with manpower and equipment to offer fire protection to a 60 square mile area in Kewaunee County, with an average population of approximately 5000 people. The fire protection territory includes the City of Kewaunee, Townships of West Kewaunee, Pierce, Casco and the Kewaunee Power Station. The fire department has eight pieces of motorized fire apparatus available and 38 firefighters who carry radio pagers to be notified in the case of a fire.

The fire department museum is a newly constructed building show piece where historical antique fire apparatus is on display. Fire department history is available for public viewing as wall mounted pictures, antique fire apparatus and equipment are there to see. Taking us back into time is the actual 1845 "Hand-Tub" pumping engine purchased from the City of Milwaukee, the



original 1884 hand pumper, a 1908 hand drawn wheeled Hose Cart, and a 1927 American LaFrance pumping engine, still in working condition. The museum is located next to the giant Grandfather Clock and Pavilion in downtown Kewaunee.

GRANDFATHER CLOCK



The 35' 10" tall grandfather clock in Kewaunee was built in 1976 (bi-centennial) by Svoboda Industries as a hallmark of their business and a gift to the people of Kewaunee. It was built by Jake Schlies with the help of his son, Rodney. In 1984, a new bridge was built in Kewaunee and Svoboda would move its business and the clock to their new Top of the Hill Shop located on Hwy 42 on the northeast edge of Kewaunee. Svoboda's closed the shop and the clock stayed behind and was neglected for more than a decade before selling the property to the Kewaunee County Sheriff's Department in 2013. The clock would now be forced to relocate or be dismantled permanently since the Sheriff's Department planned on using the building for storage. This created a whirlwind of excitement since other cities had interest in taking the clock out of Kewaunee to be restored and used.

Jason Jelinek began a grass root movement using local news outlets and social media to garner attention and support to save a historic piece of Kewaunee, but also a true Americana road side attraction. With full support of Sheriff Matt Joski and soon after Mayor John Blaha, approval to move the clock to its new home at the corner of Miller Street and Hwy 42/Milwaukee Street at the head of the Anhaapee Trail was unanimously voted for by the city council in March 2013.

The clock was dismantled in June 2013 for restoration. The body, which was mostly made of redwood, was rotted and replaced with marine grade plywood. A new footing was poured and the steel I-beam backbone inside the clock had extra support struts welded in for bolting to the footing. The ornate clock head was restored through the winter mainly by Dale (Whitey) Vandermoss and his brother, Mike Vandermoss, whom recreated some of the large spindles, coved and crowned moldings by hand. While the outside was being repaired, the German made motors of the clock were looked over by Hacker Berkovitz and made sure they were all keeping time.

On August 27, 2014, the clock body and head were raised in its current home downtown Kewaunee facing the harbor. It would stand alone through the winter of 2014/2015. On May 1, 2015, two pavilion roofs were erected off of each backside of the clock. One running north and south, the other east and west.

On July 30th at 1:00 P.M. the clock was officially started and has been keeping perfect time since. As of December 5, 2015, a sound system was donated and chimes along with music for the seasons can be heard on the quarter, half, and full hours.

All funding to move and restore the clock was provided by donations from local citizens. A true testament to the attachment locals had with the icon. Over \$30,000 was raised and funds continue to support the beautification of the Anhaapee Trail head area as well as general maintenance, signage, and electricity. There are many local craftsmen and women, construction companies, including Merten's Construction and Concrete, Schlies Construction and Remodeling, Scott's Industrial Coatings, and Northern Sound and Video, government officials and supporters that deserve a great amount of thanks for the volunteer work that was given so graciously! Thank you all so much! This is the world's Tallest Grandfather Clock!

KEWAUNEE PIERHEAD LIGHTHOUSE



The Kewaunee Pierhead Lighthouse is a beloved community icon and a reminder of the local maritime history shared by the early settlers, sailors, and the recreational enthusiasts of today. Still serving as an active aid to navigation, the City of Kewaunee received ownership of the lighthouse

from the National Park Service in 2011. Working together with the non-profit "Friends of the Kewaunee Pierhead Lighthouse," restoration is underway!

The first lighthouse in Kewaunee was built in 1889 on the original, wooden North pier. The arrangement of this lighthouse on the pier was changed several times until it was decided a new lighthouse was to be built on a new concrete pier, the new lighthouse being equipped with the most modern equipment.

In 1911 & 1912, the current South pier was built out of concrete. At the end of the pier was built an open frame light tower, with a fog signal building immediately behind it. An elevated walkway was also built along the entire length of the pier to allow the keepers to access the lighthouse safely above the crashing waves. Two 45 h.p. engines inside the building provided compressed air for a 10" diameter chime whistle, sounded in poor visibility. When the new lighthouse was complete in March of 1912, the 5th order Fresnel (fruh-NELL) lens that had lit the old tower on the North pier was moved to the South pier, and the former range lights and steam fog signal building on the wooden North Pier destroyed.

In 1919, electricity was run out to the lighthouse and the light itself electrified. The air compressor engines were replaced with an electric motor, but a gasoline engine was maintained as a backup. The whistle was replaced by a more modern signal, the "Type F" Diaphone. In November 1930, the lighthouse tower was damaged in a collision from a railroad ferry attempting to enter the harbor. The damaged tower was removed by barge and the current light tower built from the roof of the fog signal building. In 1981, the light was



Located downtown Kewaunee
222 Ellis St.

We specialize in adorable and affordable
women's clothing and accessories.

Casual to special occasion wear.

Private parties available.



KEWAUNEE PIERHEAD LIGHTHOUSE

fully automated and the keepers were removed. Shortly after, the elevated walkway was removed as well, and the lighthouse sat nearly abandoned.

After acquiring the lighthouse in 2011, the City of Kewaunee was awarded a state grant in 2015 for the repair of the harbor seawall and the stabilization of the lighthouse. The main focus was to protect the lighthouse structure from the elements and curtail further damage. The initial stabilization took place in 2017 as a massive exterior restoration. Further restoration projects have been completed since, including a new entry door and larger entry platform, installing new windows on the main level, and reinstalling electricity throughout the building.

The 5th Order Fresnel lens, originally installed on the North Pier in 1902, was decommissioned in 2019 and replaced with an LED beacon. The lens is on permanent loan from the Coast Guard and is on display at the Kewaunee History Center.

Kewaunee's square lighthouse, closely resembling the Holland, Michigan Lighthouse, is white with a red roof. The light sits 43 feet above Lake Michigan, and the light characteristic is fixed (or steady) white. The lighthouse spans 5 decks, from the massive fuel oil tanks at the pier level, to the lantern and parapet high above the lake.

The Kewaunee Pierhead Lighthouse is currently undergoing restoration. The lighthouse opens for public tours on selected dates throughout the summer, staffed by volunteers. Suggested donation of \$5/adult and \$3/child.

Visit KewauneePierheadLighthouse.org for more information and to support the effort!

PARALLEL 44 | DOOR 44
VINEYARD & WINERY

10% OFF
YOUR PURCHASE
EXPIRES 12-31-2024

Not redeemable for cash. One coupon per visitor or per day. Must be legal drinking age. Not to be combined with other offers.



Our passion is producing award winning wines from locally grown grapes. Sample our wines, stroll our vineyard, tour our winery, and experience local!

Explore, Share & Enjoy!

2023
WINERY
OF THE
YEAR

PARALLEL 44 VINEYARD & WINERY
N2185 SLEEPY HOLLOW RD
KEWAUNEE, WI / 920-388-4400
BTW. I-43 & HWY 42, Just east of Green Bay
PARALLEL44.COM



DOOR 44 WINERY
5464 COUNTY ROAD P
STURGEON BAY, WI / 888-932-0044
Corner of HWY 42 & P. Driveway on P.
DOOR44WINERY.COM

Visit & Shop

WWW.44WINERIES.COM



37

RAISE YOUR GLASS TO KEWAUNEE COUNTY WINERIES

What makes Kewaunee County's wines some of the best in Midwest? Is it the fact that the average rainfall is within one inch of Bordeaux, France? Or that the hours of daylight are the same as Tuscany, Italy? Or is it the cool waters of Lake Michigan during the summer? Or is it the perfect soil for growing the many varieties of grapes?

The answer... YES! Kewaunee County, and the entire northeastern Wisconsin area is part of the Wisconsin Ledge, which is an American Viticultural Area (AVA) since 2012. The Wisconsin Ledge is the third AVA designation in the State.



The history of wineries in Kewaunee County begins with von Stiehl Winery in Algoma. In 1967, Dr. Stiehl opened the first winery in the state and produced his wines from Door County cherries and apples. Doc Stiehl sold the winery to Bill and Sandy Schmiling in 1981. At that time, the winery produces about 5,000 gallons of wine a year with 90% of it cherry.

In 2003, Bill and Sandy sold the winery to their sons, Aric and Brad. Today, fifty years later, von Stiehl Winery produces forty grape and fruit wines. The latest technology is used in producing over 75,000 gallons of wine, while still paying attention to detail, just as Doc did in the early days. Today, you can take a tour of the winery, sip a glass of wine on the three-tier terrace overlooking the Algoma lighthouse, take part in the many pairing events throughout the year and annually in September, celebrate with us at the Wet Whistle Wine Fest and take part in the Grape Stomp!

What started as a dream for two newlyweds on their California honeymoon in 1994 has turned into a pioneering vineyard and winery in the heart of Kewaunee County since 2005. Steve and Maria Johnson, while sitting in the middle of a vineyard turned to each other and said, "Why don't we do the same thing back home in Wisconsin?" At that time, this notion of pioneering a world class wine region in the heart of the "Frozen Tundra" seemed like an impossibility to most everyone.

Since that time, Steve, Maria and their three children have spent the last 16 years growing grapes and making wines that are winning international acclaim. Our namesake is also our actual geographic location, Parallel 44 or 44 degrees North Latitude. Follow this same line of



RAISE YOUR GLASS TO KEWAUNEE COUNTY WINERIES

latitude and you would find yourself walking through vineyards of Bordeaux, France and Tuscany, Italy. This means you will find the same perfect grape growing conditions (growing degree days, length of daylight and precipitation) here in Kewaunee County.

We invite you to walk the vineyards, take a tour, or relax on the patio overlooking our 10 acre vineyard. At Parallel 44 you will learn, enjoy, and experience why we are the largest producer of "Wisconsin Ledge" Wines in the state. Virtually every wine you taste is "Wisconsin" from ground to glass. Become a wine pioneer with us and immerse yourself with wines and stories that are world class and distinctly and proudly Wisconsin!



The newest winery in Kewaunee County is Cold Country Vines & Wines, which is located four miles from Lake Michigan, perched along the edge of the beautiful East Twin River Valley. Jay Stoeger grew up helping his grandparents and his uncles grow grapes and other fruit, much of it for wine in the Marinette/Peshigo area. Concord grapes were the most cold hardy, but even those would only produce a crop about three out of every five years. Most of the other varieties grown back then were lucky to produce a crop one year out of every five. Sadly, Jay could only dream about growing grapes and making wine. That is until the late 1990's when a Wisconsin native, Elmer Swenson, revolutionized grape growing in the Upper Midwest and other cold and short-seasoned regions. He started cross breeding and developing grape varieties that would not only survive the cold Wisconsin winters, but would also make a great wine.

Once Jay became aware of these new, cold hardy grapes, his dream could finally become reality. Since Jay's wife Kay shared his passion for wine, it didn't take much convincing to get her to agree to start planting grapes and planning the conversion of their horse barn into a winery. Today, it stands



beautifully in the center of their 16-acre vineyard. Jay and Kay invite you to join them in a toast to the beginning of a new era of fine Cold Country Wines – born from a dream; nurtured by a passion; brought to fruition by commitment to producing the finest wines with the distinctiveness that can only be derived from exceptional varieties of cold climate cultivars.

DISCOVER COLD COUNTRY WINES



Summer Hours: Open Daily
Mon-Sat 10am-5pm, Sun 12pm-5pm
Winter Hours: Vary
Call ahead or check online



*From Kewaunee: Drive south on
Highway 42 for 9 miles. Turn right
on Nuclear Road for 3.5 miles.
Cold Country is on the left.*

920-776-1328
E3207 Nuclear Rd
Kewaunee, WI 54216
coldcountrywines.com

CHAMBER MEMBER BUSINESS DIRECTORY

920 area code unless specified elsewhere

Emergency 911

Information

Kewaunee Area Chamber of Commerce	388-4822
Kewaunee Co. Parks & Rec Dept.	388-0444
Hotline	388-7199
Kewaunee Co. Economic Development Corp.	255-1661

Schools

Kewaunee Grade /Middle School	388-2458
Kewaunee High School	388-2951
Kewaunee Superintendent	388-3230
Holy Rosary Catholic School	388-2285
NWTC	845-5945

Library

Kewaunee Public Library	388-5015
-------------------------	----------

Local Government

Kewaunee City Hall	388-5000
Kewaunee Fire Department	388-5006
Kewaunee Police Department	388-5010
Kewaunee Rescue Squad	388-5000
Kewaunee Sheriffs Department	388-3100
Kewaunee Street Department	388-5002
Kewaunee Water & Sewer Dept.	388-5013
Kewaunee County Courthouse	388-7133

Churches

Community Congregational Church	388-2719
Holy Rosary Catholic Church	388-4321
Immanuel Ev. Lutheran Church	388-2592
Lakeshore Baptist Church	606-6901

AGRIBUSINESS

Alpaca to Apparel	536-1394
Heims Hillcrest Dairy	536-0118
Pagel's Ponderosa	388-3333

APPAREL/BOUIQUE

Alpaca to Apparel	536-1394
Dalli Moo	680-3344
Lighthouse Gift Shop	388-3565
Pretty Please Boutique	333-3601

APPLIANCES

Harv's Electric	388-3699
-----------------	----------

ART GALLERIES/SCHOOLS

Kewaunee Artisan Center	304-8018
-------------------------	----------

AUTO SALES AND REPAIRS

Blaha Body Shop	388-2730
Carter's Collision	388-2950
Jorns Chevrolet	388-0520

BANQUET/MEETING FACILITIES

Agricultural Heritage and Resource Inc.	388-0604
Lakehaven Hall	255-3328
Northbrook Golf & Grill	845-2306

BAKERIES

The Bakery Bar	388-0268
Piggly Wiggly - Kewaunee	388-2311

BREWERY

Ahnapee Brewery	785-0822
-----------------	----------

BUILDERS

Keller	800-236-2534
--------	--------------

CAMPING

Kewaunee Marina	388-3300
Kewaunee RV & Campground LLC	388-4851
Maple View Campground	776-1588

CHARTER FISHING BOATS

Andrew LaFond Charters	388-0577
Fishin' Again Charters	304-0216
Harbor View Charters	217-3776
Home Wrecker	536-0080
Predator	606-3733

CHILDCARE

Holy Rosary Childcare	388-2285
-----------------------	----------

CHRISTMAS TREE FARM

Aissen Tree Farm	845-5554
------------------	----------



**Kewaunee County
Economic Development
Corporation**

Find out how to start or grow
your business here: KCEDC.org

CHAMBER MEMBER BUSINESS DIRECTORY

920 area code unless specified elsewhere

CLEANING SERVICES

Team Clean.255-5975

DENTISTRY

Letter/Sperber Dentistry.388-5200

DISTRIBUTORS

Flanigan Distributors.743-2036

DAIRY/CHEESE

Heims Hillcrest Dairy.536-0118

Pagel's Ponderosa.388-3333

Ron's Cheese.845-5330

Wakker Cheese.388-6500

ELECTRICAL SERVICES

Harv's Electric.388-3699

FINANCIAL INSTITUTIONS/INVESTORS

Equitable Advisors.388-2706

Bank of Luxemburg.388-2111

Algoma 487-5288

Luxemburg 845-2345

Nicolet National Bank.388-2040

Algoma 487-3421

Luxemburg 845-1005

FISH MARKETS

LaFonds Fish Market.388-0577

FUNERAL HOME

Kinnard Funeral Home.888-926-3660

FURNITURE/FLOORING

McMahon's of Luxemburg.845-2341

GARDEN CLUB

Kewaunee County Garden Club.680-5384

GOLF COURSES/OUTDOOR REC

Alaskan Golf Club.388-3940

Northbrook Golf & Grill.845-2383

GROCERY STORES

Glenn Innish Farm.251-7450

Piggly Wiggly - Kewaunee.388-2311

HEALTH SERVICES

Bellin Health.388-4640

Kewaunee Health & Fitness.388-4961

Lakeshore Vision Center.Kewaunee 388-2020

Algoma 487-2020

Prevea Health.272-1008



An Oshkosh Corporation Company

1941 ————— 2024

A PROUD PAST — AN EXCITING FUTURE

**520 Main Street, Kewaunee
920-388-2000**

CHAMBER MEMBER BUSINESS DIRECTORY

920 area code unless specified elsewhere

HOME CARE

Jay's Legacy Home Care901-7780

INSURANCE

Equitable Advisors.....338-2706

Novak Agency Inc.388-2890

INTERNET

Bug Tussel Wireless.....1-888-722-0924

JEWELRY

Aude Jewelers845-5860

LODGING

Coho Motel and Lighthouse Shop388-3565

Harbor Lights Lodge388-3700

Harrison Harbour House388-0606

MANUFACTURING

Kewaunee Fabrications388-2000

MARINAS/SALES AND SERVICES

Kewaunee Marina388-3300

Yacht Works388-2120

MEAT MARKETS

Al-Vi Lane Farm973-1295

Glenn Innish Farm251-7450

Konop Meats, Inc.388-3892

NEWSPAPERS

Kewaunee County Star News499-1200

NON-PROFIT ORGANIZATIONS

ADRC of the Lakeshore877-416-7083

American Legion - Post 29Kewaunee

Don & Jean Smith Memorial FundKewaunee

Friends of Kewaunee Library660-5546

Home & Community Education.702-927-0969

Kewaunee Area Chamber of Commerce.388-4822

Kewaunee Art Beat487-3840

Kewaunee Artisan Center304-8018

Kewaunee County Association for Home

and Community Education255-2546

Kewaunee County Economic Development Corp. 255-1661

Kewaunee County Food Pantry487-3663

Kewaunee County Historical Society.....388-0369

Kewaunee Lions Club388-4717

Kewaunee Rotary Club388-3430

KHS Alumni Fest388-0230

Jay's Legacy Home Care

LET US BE YOUR
Help To Stay At Home



WHO WE ARE?

We're a small business, dedicated to providing quality care to you and your loved one. Located right here in Northeastern Wisconsin, we can provide the personal touches that larger companies cannot. Sometimes families just need a little respite care, family support for Alzheimer's, transitional help after surgeries and a little help with every day needs.



CALL US FOR MORE INFO

 920-901-7780

 renejdjayslegacy@gmail.com

 www.jays-legacy.com

WHAT WE DO?

We provide non-medical help and companionship based on your individual needs.

Examples of services provided include:
Housekeeping, cooking, meal prep, medication reminders, laundry, grocery shopping, appointments and help with bathing and dressing. We're here to promote independence and help you stay at home.

CALL US FOR EMPLOYMENT POSITIONS

 920-901-7779



BBB Rating: A+
As of 9/26/2022
[Click for Profile](#)



**LOCAL AGENTS
LOCAL KNOWLEDGE
LOCAL EXPERIENCE**

**When it comes to real estate in
Door and Kewaunee Counties,
it pays to work with a member of the
Door County Board of REALTORS®**

**TO FIND A
DCBR MEMBER,
SCAN HERE**



CHAMBER MEMBER BUSINESS DIRECTORY

920 area code unless specified elsewhere

Lakeshore Community Food Pantry & Thrift Shop 388-9050
 Mishicot Area Growth & Improvement ... 755-3411
 Muskrat City Sportsman Club ... 255-1309
 NWTC ... 845-5945
 Shrine of Our Lady of Good Help ... 866-2571
 Veterans of Foreign Wars,
 Ralph Perry Post 3392 ... 304-6016
 Violence Intervention Project ... 487-2111
 Help Line ... 837-2424
 Zoological Society ... 388-0444

POINTS OF INTEREST

Ahnapee Trail ... 388-0444
 Besadny Fisheries Facility ... 388-1025
 Kewaunee County Historical Society Center ... 388-0369
 Kewaunee Historical Jail Museum ... 388-7176
 Marquette Historical District ... 388-0618
 Shrine of Our Lady of Champion ... 866-2571
 The Tug Ludington, Harbor Park ... 388-5000

PRINTING

Heyrman Printing ... 499-4815

TITLE SERVICES

Light House Title ... 388-2226

REALTORS

Door County Board of Realtors ... 743-9651
 The Woods, Shorewest Realtors.. 883-9590 & 883-6338

RESTAURANTS/PUBS

Alaskan Golf Club ... 388-3940
 The Ballering ... 388-6011
 The Blue Door ... 388-6063
 The Bucket ... 388-9987
 Gibs on the Lake ... 776-1551
 Homestead ... 487-0105
 Kewaunee Custard ... 388-0720
 Northbrook Country Club ... 845-2306
 Port O' Call ... 388-4883
 Red's Pub and Grill ... 677-8499
 Roosters ... 388-2162
 Subway ... 388-3782
 Waterfront Bar and Grill ... 388-0505
 The Wildflower Supper Club ... 388-6076



This team is 5★ Rated
by previous clients



Kewaunee
Health&Fitness

Your Local Non-profit Fitness Center

www.kewauneefitness.org
 160 Terraqua Drive
 Kewaunee, WI 54216
 920-388-4961

Open 24/7 with Membership

Free Fitness & Yoga Classes for Members

Indoor Pool / Hot Tub / Walking Track

Weight Training & Cardio

Basketball, Pickleball

Swimming Lessons

CHAMBER MEMBER BUSINESS DIRECTORY

920 area code unless specified elsewhere

SPECIALTY STORES/SHOPS

Aissen Tree Farm	845-5554
Alpaca to Apparel	536-1394
Dalli Moo	680-3344
Glenn Innish Farms	251-7450
Katie Rabbit's	660-4692
Lighthouse Gift Shop	388-3565
Lilac Shanty	819-1426
Norman General Stores	301-0617

UTILITIES

Wisconsin Public Service Corp.	800-450-7260
-------------------------------------	--------------

WEDDING SITES & SERVICES

Agricultural Heritage & Resource Inc	388-0604
Lakehaven Hall	255-3328
Northbrook Golf & Grill.	845-2383

WATER TESTING

Whitewater Associates	388-9067
-----------------------------	----------

WINERIES/VINEYARDS

Cold Country Vines & Wines	776-1328
Parallel 44 Winery & Vineyard	388-4400
von Stiehl Winery	487-5208

Nicolet
NATIONAL BANK

Real People. Real Conversations.

519 Main Street
Kewaunee, WI 54216
920.388.2040
NicoletBank.com

MEMBER FDIC

Aissen Tree Farm
Pilsen, WI
WWW.AISSERTREEFARM.COM

**KEWAUNEE COUNTY'S LARGEST
CHRISTMAS GIFT SHOP ~ OVER 9000SQFT**

- OVER 7000 ORNAMENTS
- UNIQUE GIFTS
- ANTIQUES
- FRESH WREATHS, KISSING BALLS,
GARLAND, TREES
- INDOOR LIFESIZE
GINGERBREAD PLAYHOUSE

**UNIQUELY OPEN DAILY 9AM - 7PM
STARTING NOVEMBER 16 THROUGH CHRISTMAS EVE DAY**

WE ARE EASY TO FIND! JUST 10 MILES WEST OF KEWAUNEE, RIGHT ON HWY 29
E1105 STATE HWY 29, LUXEMBURG 920-845-5554

Maple View Campground

N1267 Norman Rd. Kewaunee, WI

Season: (920) 776-1588 Off Season: (920) 388-2910



Private Spring Fed Lake • 30 Beautiful Shaded Acres



**Free Hot Showers • Flush Toilets • Coin Laundry • Water
Sewer • Electric Hookups, 30 & 50 Amp • Sandy Beach
Playground • Horseshoes • Volleyball • Basketball • GaGa Pit
Horse Drawn Wagon Rides**

www.mapleviewcampground.com

Follow us on Facebook





308 North Main Street
Kewaunee, WI 54216



JORNS

Chevrolet of Kewaunee Inc

1613 Center Street

Kewaunee, WI 54216

920-388-0520

1-800-236-0010